

SD-1(H)

DC Resistance (Ω)	135 \pm 15
AC Impedance at 1 kHz (Ω)	150 \pm 30
Sensitivity at 1 kHz (dB)	115 \pm 2 at 1mW
Frequency Range (Hz)	200~4000
THD at 1 kHz	\leq 3%
Weight (g)	38
Operating Temperature ($^{\circ}$ C)	-20~+55

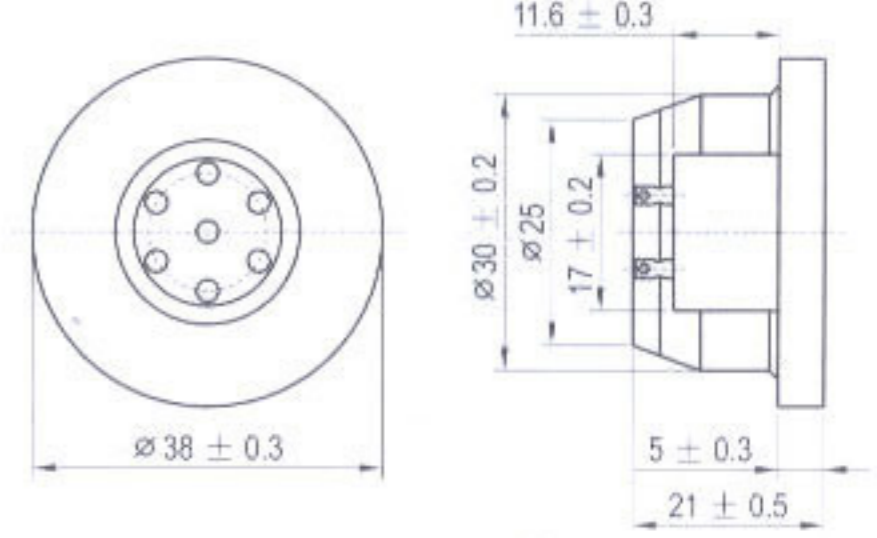
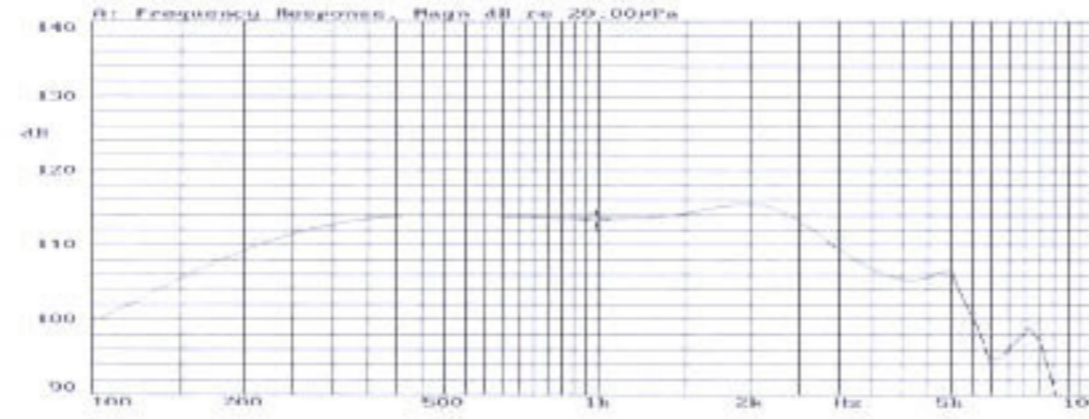

SD-2

DC Resistance (Ω)	135 \pm 10%
AC Impedance at 1 kHz (Ω)	150 \pm 20%
Sensitivity at 1 kHz (dB)	112 \pm 2 at 1mW
Frequency Range (Hz)	300~3400
THD at 1 kHz	\leq 3%
Weight (g)	18
Operating Temperature ($^{\circ}$ C)	-10~+40

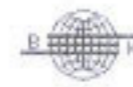
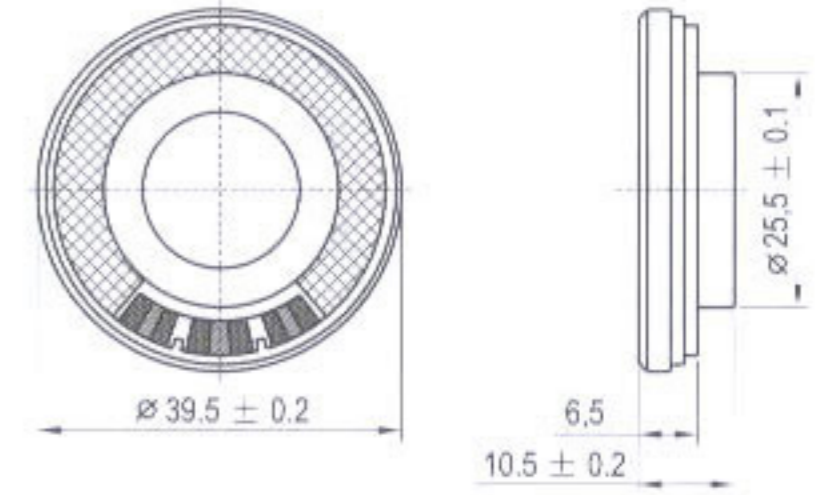
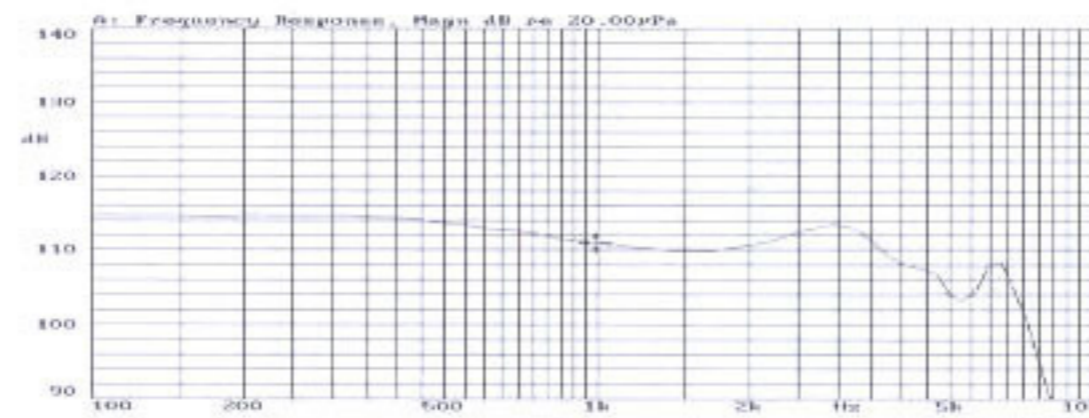

SD-3

DC Resistance (Ω)	31 \pm 7%
AC Impedance at 1 kHz (Ω)	32 \pm 15%
Sensitivity at 1 kHz (dB)	110 \pm 3 at 1mW
Frequency Range (Hz)	100~5000
THD at 1 kHz 100mV	\leq 5%
Weight (g)	1
Operating Temperature ($^{\circ}$ C)	-20~+40

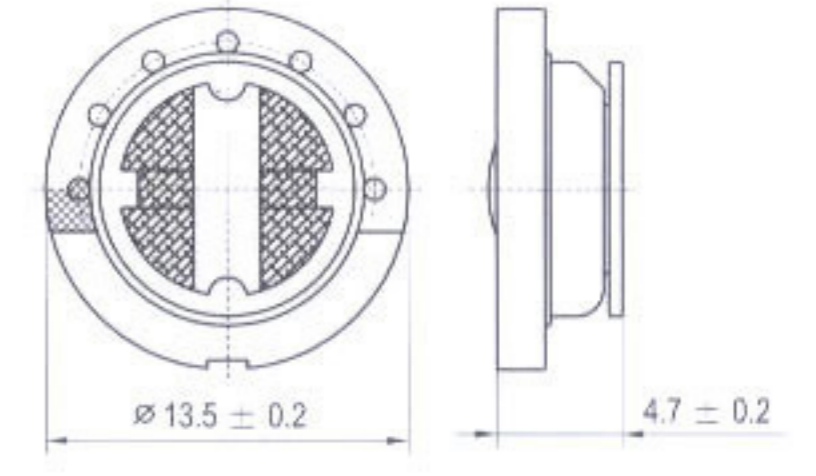
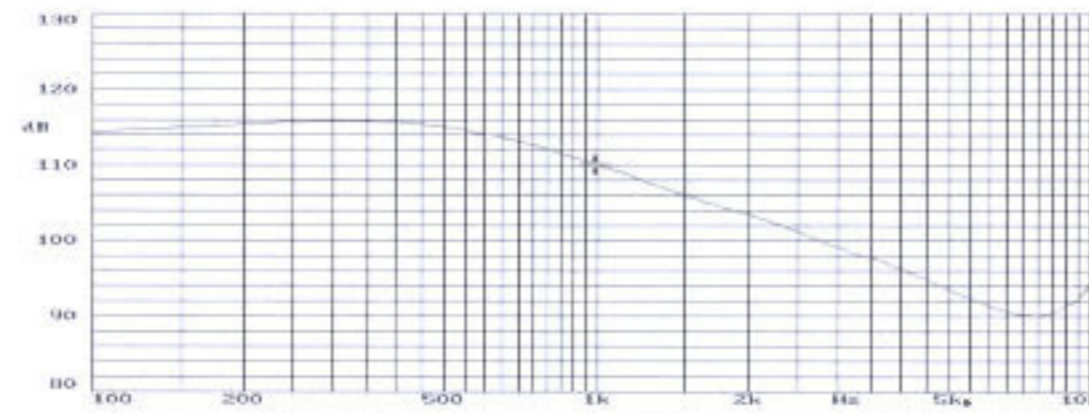

SD-3B

DC Resistance (Ω)	31 \pm 7%
AC Impedance at 1 kHz (Ω)	32 \pm 15%
Sensitivity at 1 kHz (dB)	116 \pm 3 at 1mW
Frequency Range (Hz)	100~5000
THD at 1 kHz 100mV	\leq 5%
Weight (g)	1.25
Operating Temperature ($^{\circ}$ C)	-20~+40

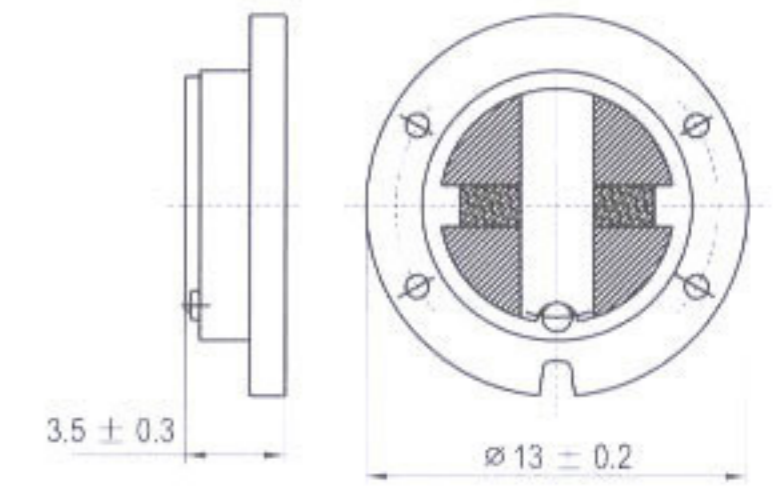
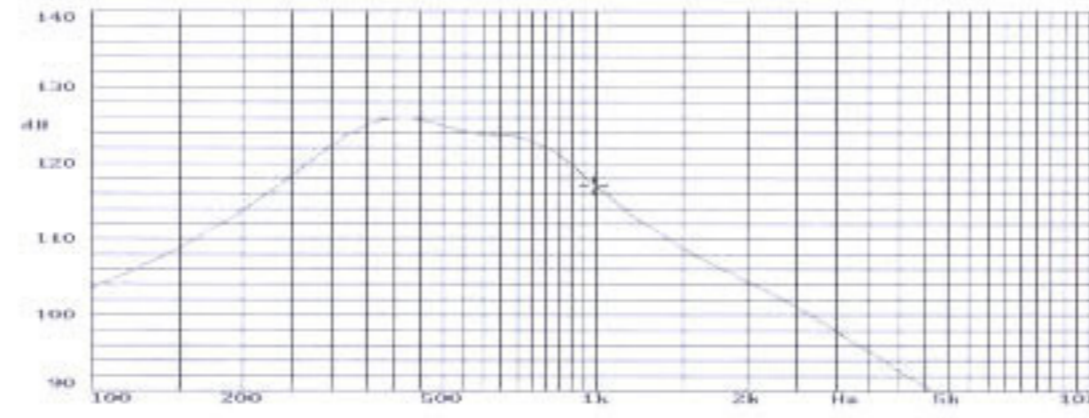



SD-4

DC Resistance (Ω)	14.5 ± 10%
AC Impedance at 1 kHz (Ω)	16 ± 20%
Sensitivity at 1 kHz (dB)	113 ± 4 at 1mW
Frequency Range (Hz)	200~4000
THD at 1 kHz 100mV	≤ 5%
Weight (g)	2
Operating Temperature (°C)	-20~+40

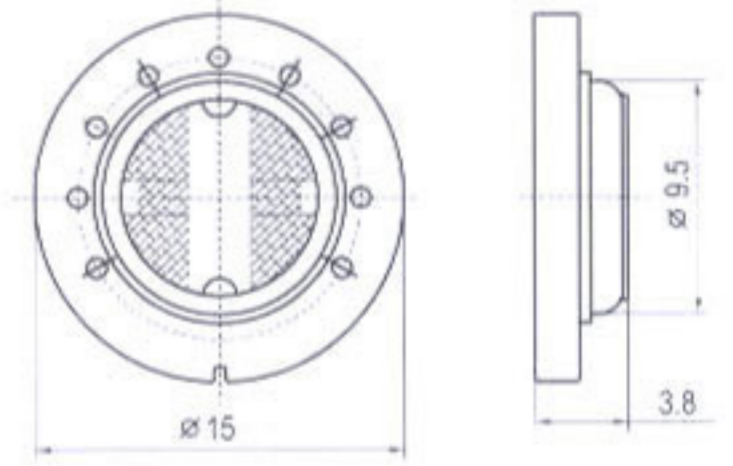
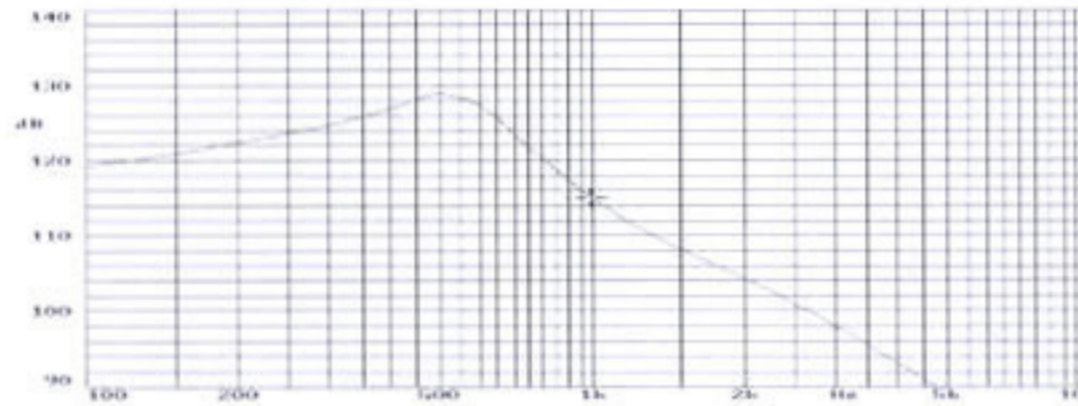

SD-5A

DC Resistance (Ω)	29.6 ± 15%
AC Impedance at 1 kHz (Ω)	32 ± 20%
Sensitivity at 1 kHz (dB)	98 ± 3 at 1mW
Frequency Range (Hz)	300~3400
THD at 1 kHz 100dB SPL	≤ 5%
Weight (g)	3.5
Operating Temperature (°C)	-20~+55

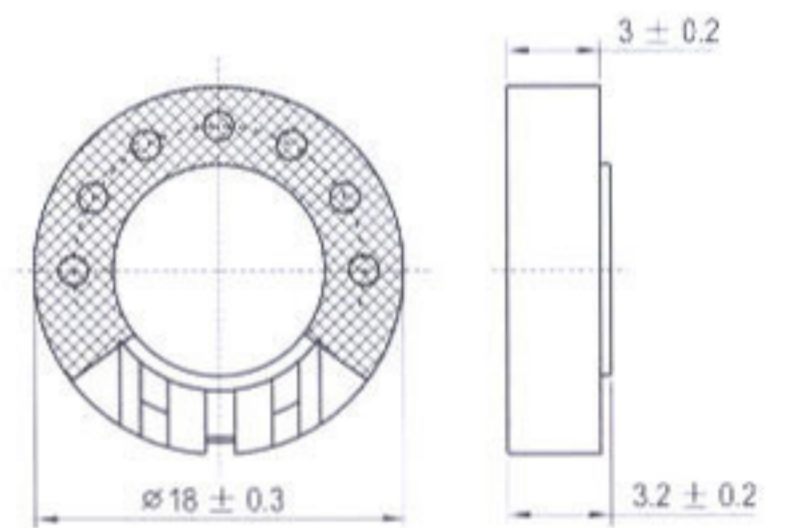
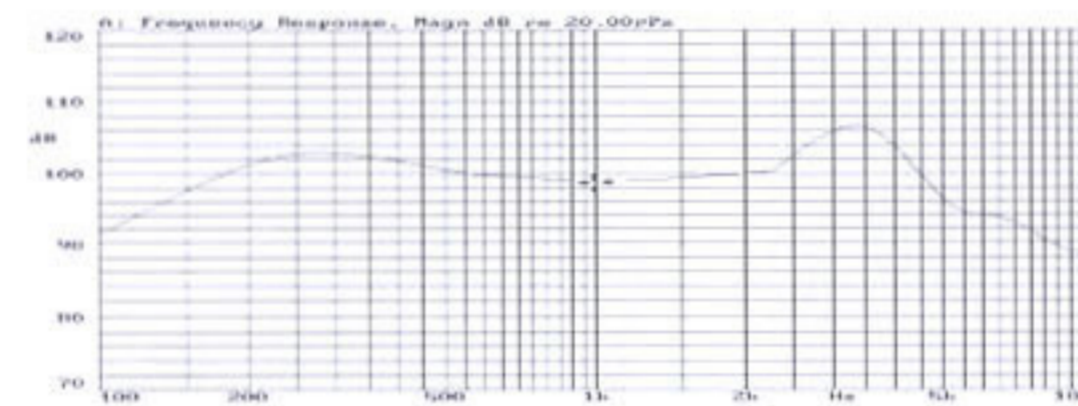

SD-6

DC Resistance (Ω)	90 ± 10%
AC Impedance at 1 kHz (Ω)	100 ± 20%
Sensitivity at 1 kHz (dB)	105 ± 3 at 100mV
Frequency Range (Hz)	50~5000
THD at 1 kHz 100dB SPL	≤ 2%
Weight (g)	6
Operating Temperature (°C)	-10~+40

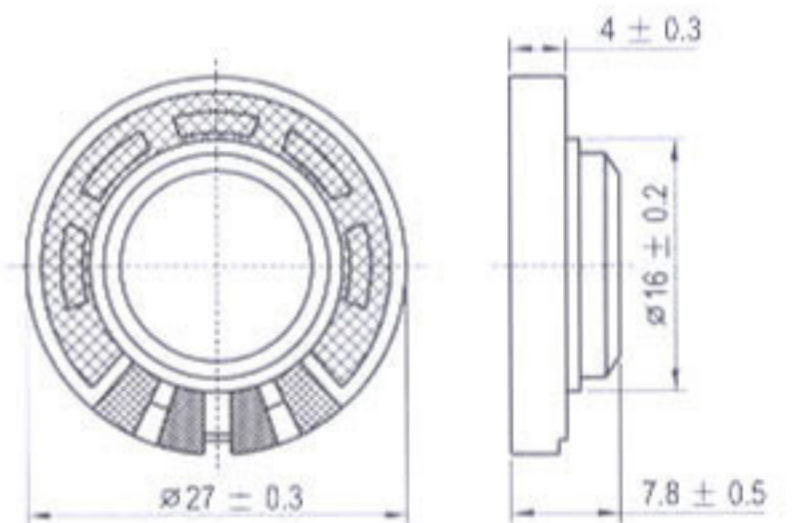
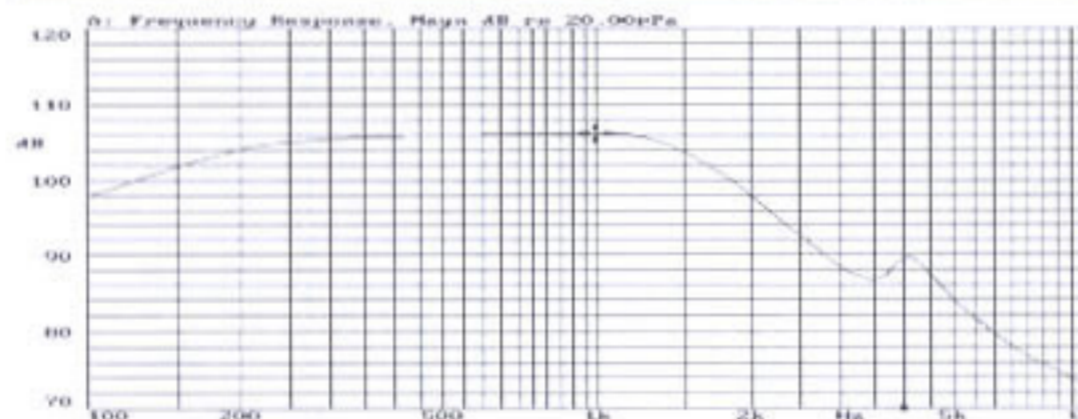

SD-7

DC Resistance (Ω)	30 ± 10%
AC Impedance at 1 kHz (Ω)	32 ± 20%
Sensitivity at 1 kHz (dB)	104 ± 3 at 1mW
Frequency Range (Hz)	200~4000
THD at 1 kHz	≤ 3%
Weight (g)	2.2
Operating Temperature (°C)	-20~+40

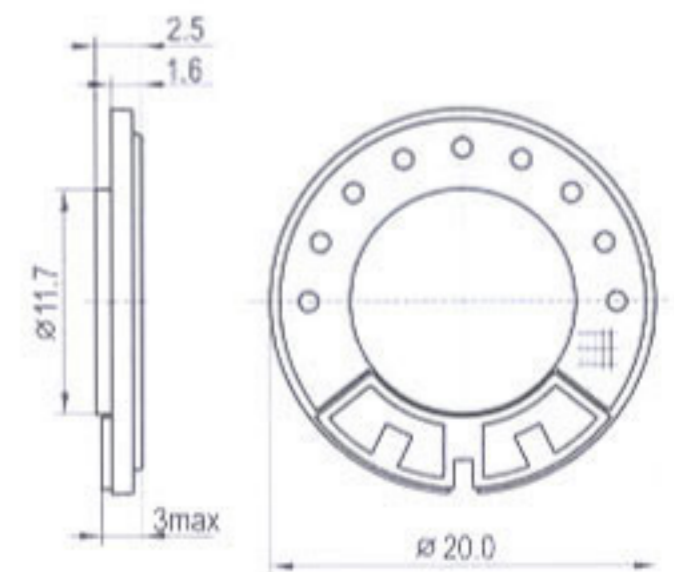
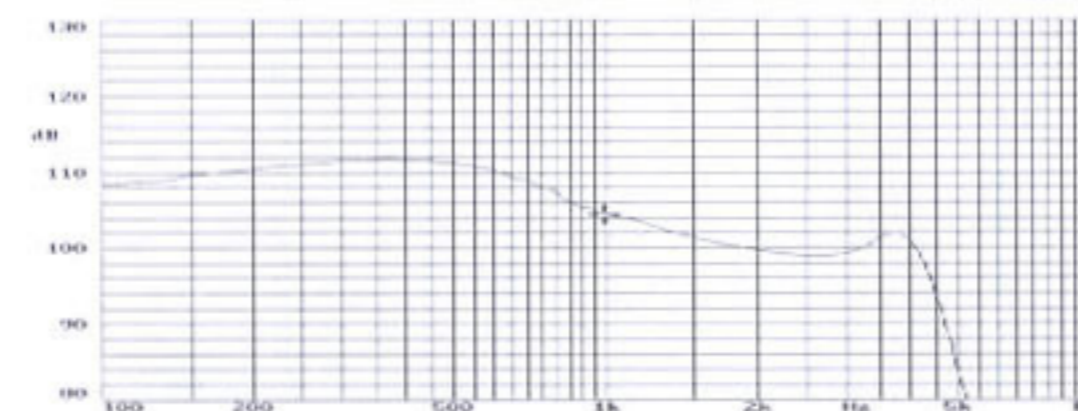



SD-9(H)

DC Resistance (Ω)	135 ± 10%
AC Impedance at 1 kHz (Ω)	150 ± 20%
Sensitivity at 1 kHz (dB)	90 ± 3 at 60mV
Frequency Range (Hz)	300~3400
THD at 1 kHz 100dB SPL	≤ 5%
Weight (g)	5
Operating Temperature (°C)	-20~+55

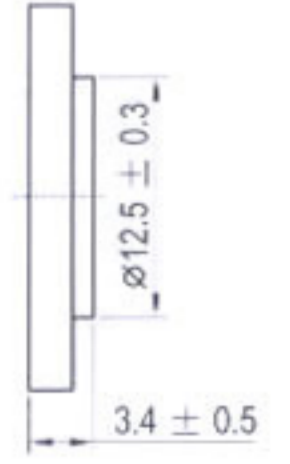
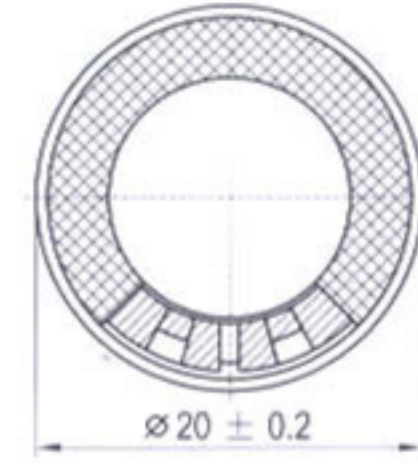
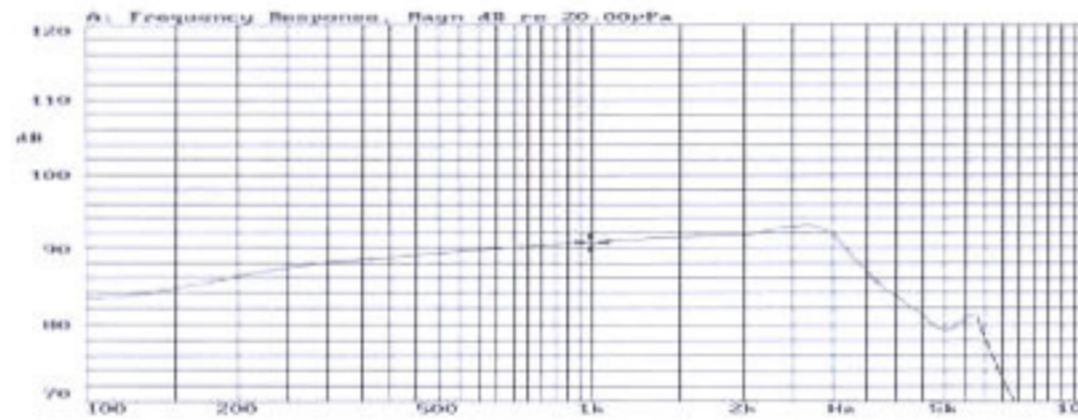

SD-10(H)

DC Resistance (Ω)	135 ± 10%
AC Impedance at 1 kHz (Ω)	150 ± 20%
Sensitivity at 1 kHz (dB)	93 ± 2 at 60mV
Frequency Range (Hz)	300~3400
THD at 1 kHz	≤ 3%
Weight (g)	5
Operating Temperature (°C)	-20~+55

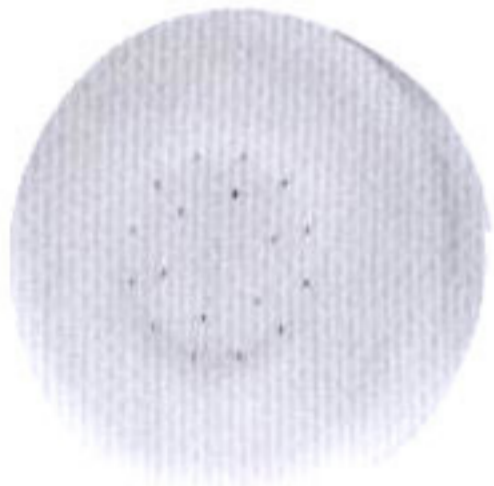
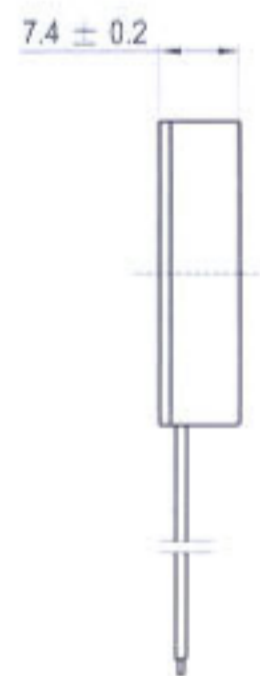
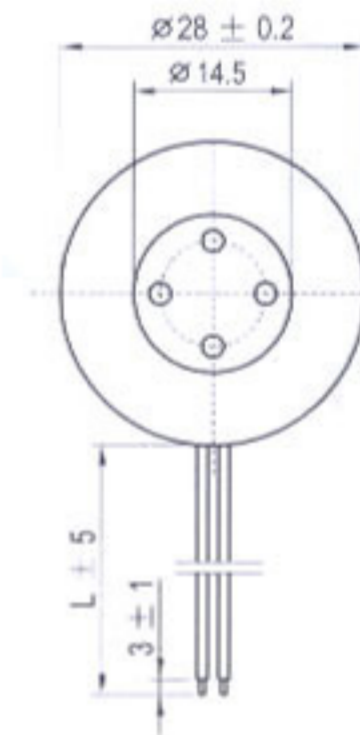
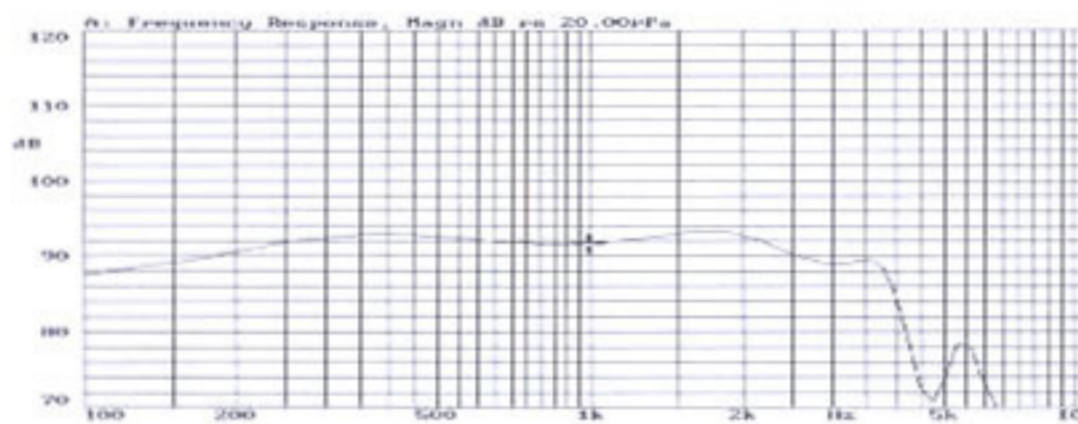

SD-14

DC Resistance (Ω)	135 ± 15
AC Impedance at 1 kHz (Ω)	150 ± 30
Sensitivity at 1 kHz (dB)	110 ± 3 at 1mW
Frequency Range (Hz)	200~5000
THD at 1 kHz 100dB SPL	≤ 3%
Weight (g)	22
Operating Temperature (°C)	-20~+55

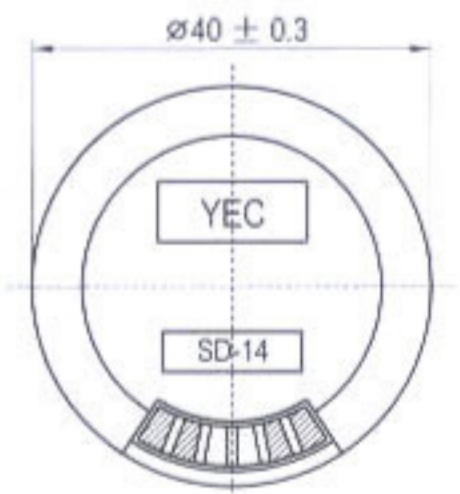
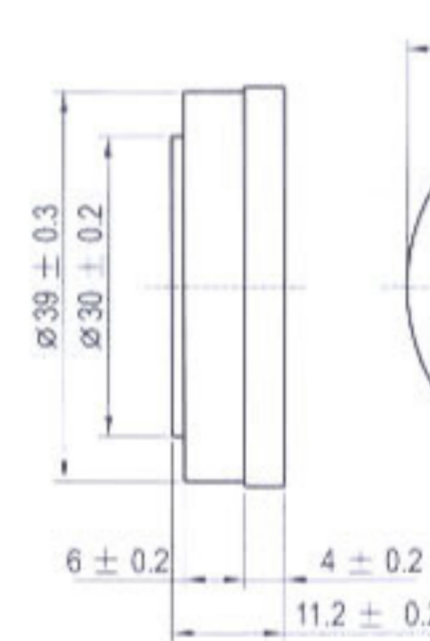
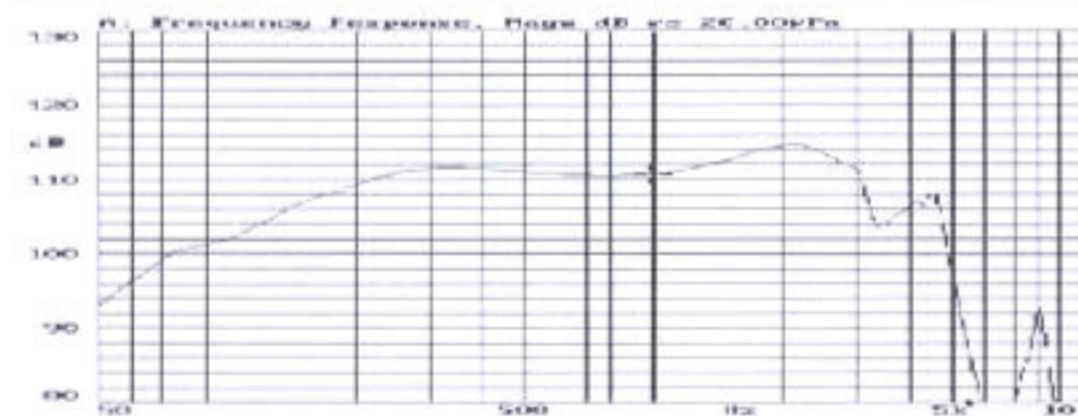

SD-15

DC Resistance (Ω)	135 ± 15
AC Impedance at 1 kHz (Ω)	150 ± 30
Sensitivity at 1 kHz (dB)	116 ± 2 at 1mW
Frequency Range (Hz)	200~4000
THD at 1 kHz 110dB SPL	≤ 5%
Weight (g)	67
Operating Temperature (°C)	-20~+55

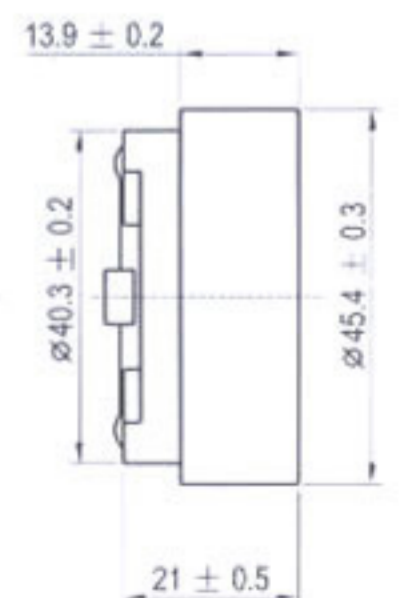
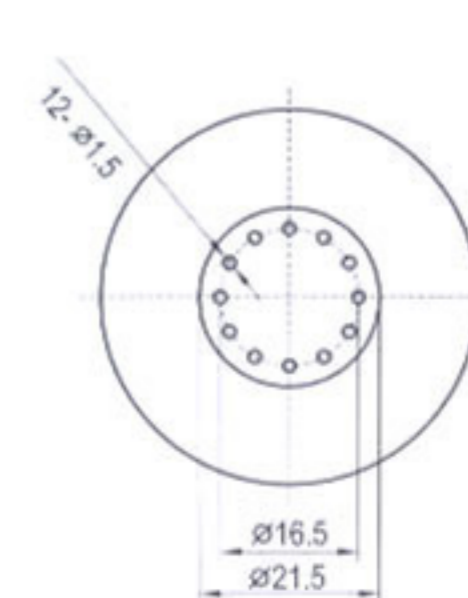
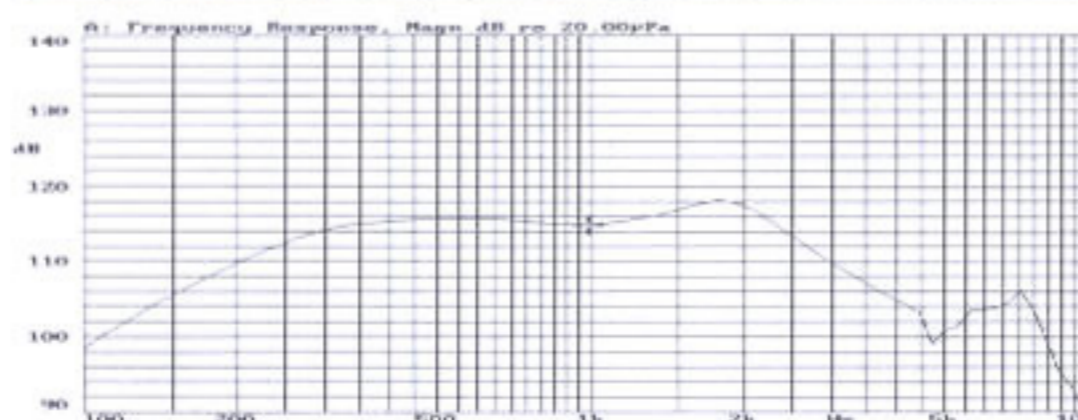

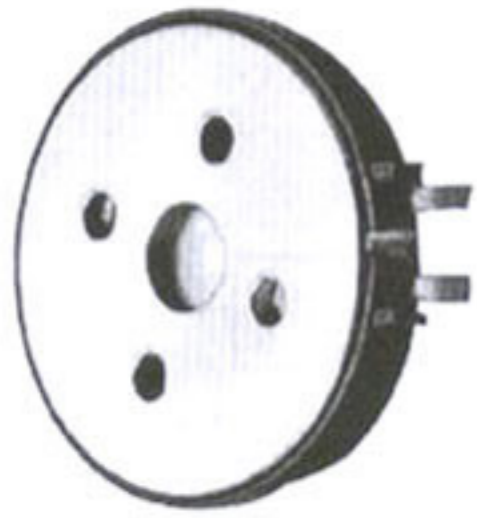

SD-16

DC Resistance (Ω)	135 \pm 10%
AC Impedance at 1 kHz (Ω)	150 \pm 20%
Sensitivity at 1 kHz (dB)	116 \pm 3 at 1v
Frequency Range (Hz)	300~3400
THD at 1 kHz 105dB SPL	\leq 2%
Weight (g)	3.2
Operating Temperature ($^{\circ}$ C)	-40~+70

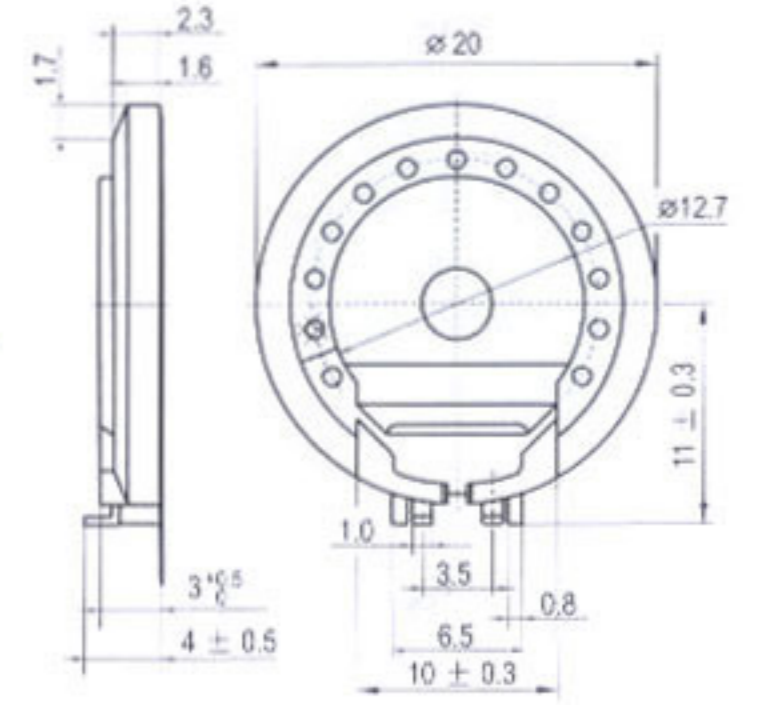
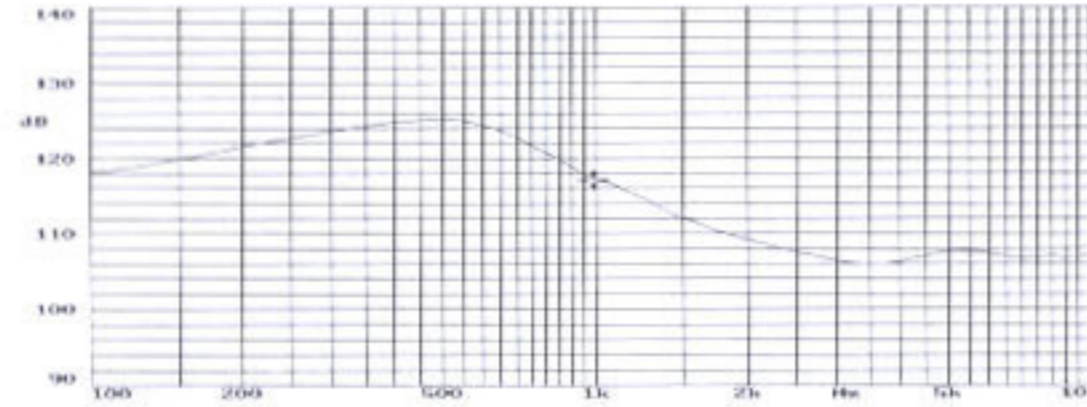

SD-19

DC Resistance (Ω)	135 \pm 10%
AC Impedance at 1 kHz (Ω)	150 \pm 20%
Sensitivity at 1 kHz (dB)	112 \pm 3 at 1mW
Frequency Range (Hz)	200~4000
THD at 1 kHz 110dB SPL	\leq 5%
Weight (g)	32
Operating Temperature ($^{\circ}$ C)	-20~+55

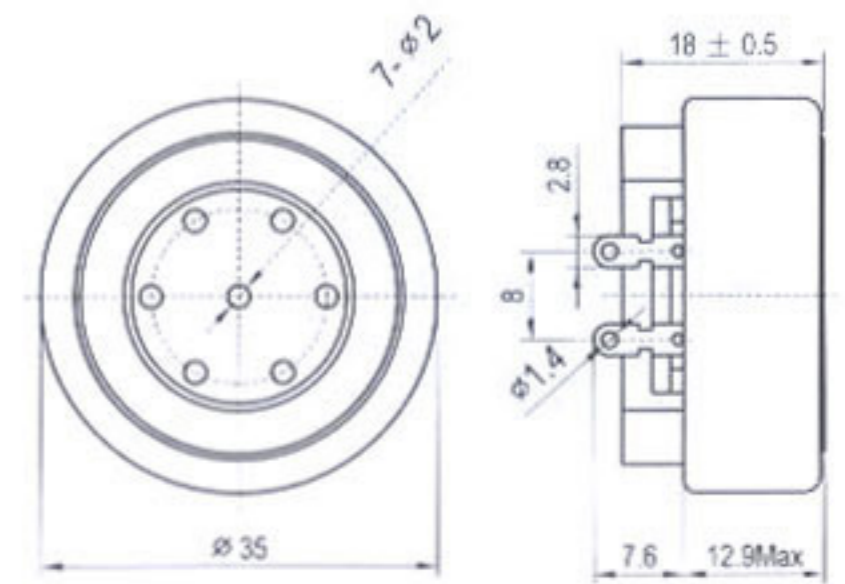
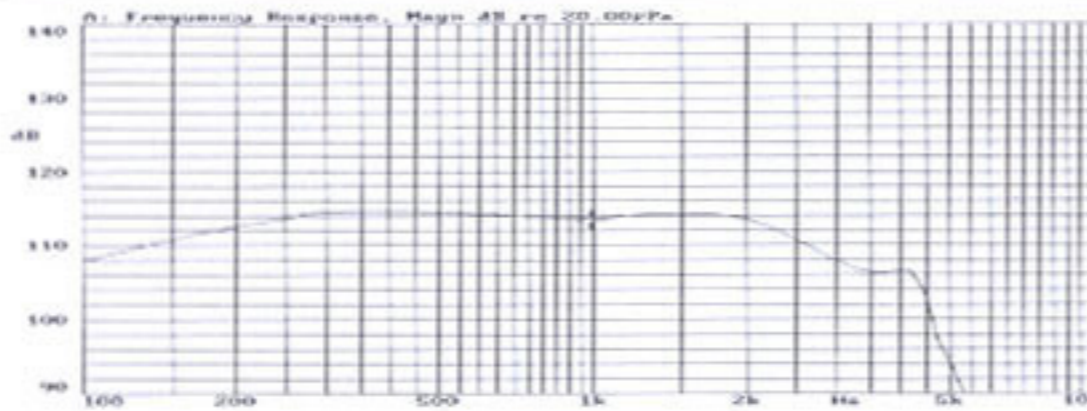

TOL: \pm 0.2



SD-22(H)

DC Resistance (Ω)	135 \pm 10%
AC Impedance at 1 kHz (Ω)	150 \pm 15%
Sensitivity at 1 kHz (dB)	98 \pm 2 at 60mV
Frequency Range (Hz)	200~4000
THD at 1 kHz	\leq 5%
Weight (g)	30
Operating Temperature ($^{\circ}$ C)	-20~+60

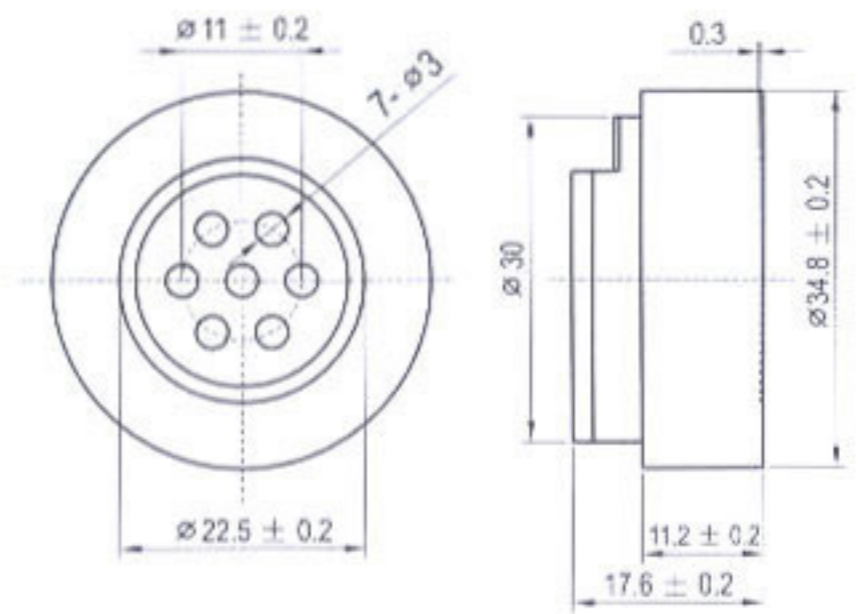
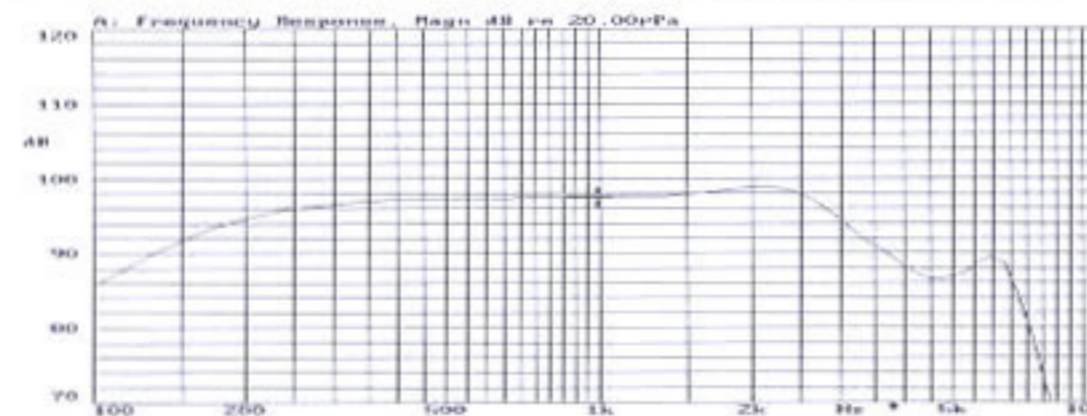

SD-22HG

DC Resistance (Ω)	135 \pm 15
AC Impedance at 1 kHz (Ω)	150 \pm 30
Sensitivity at 1 kHz (dB)	97 \pm 2 at 60mV
Frequency Range (Hz)	200~4000
THD at 1 kHz	\leq 5%
Weight (g)	30
Operating Temperature ($^{\circ}$ C)	-20~+60

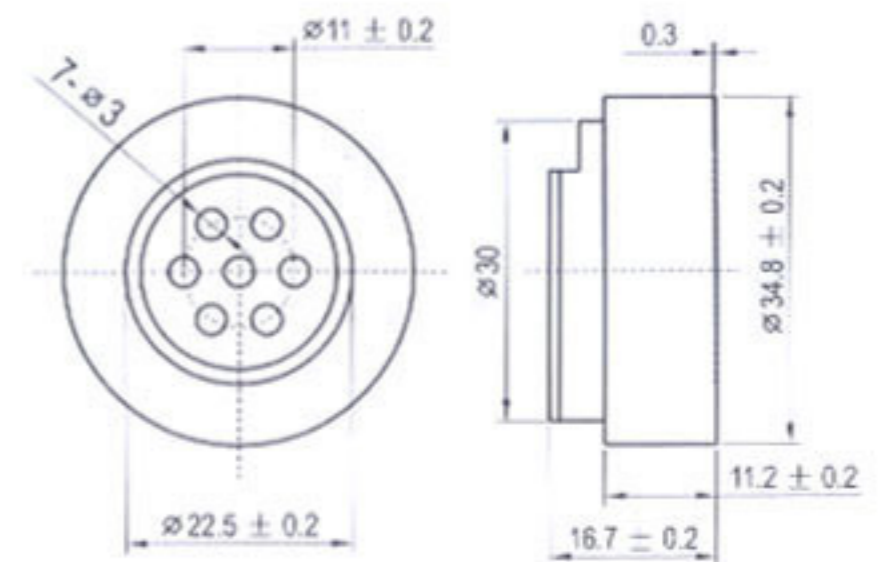



SD-24

DC Resistance (Ω)	135 \pm 15
AC Impedance at 1 kHz (Ω)	150 \pm 30
Sensitivity at 1 kHz (dB)	90 \pm 3 at 60mV
Frequency Range (Hz)	200~4000
THD at 1 kHz	\leq 5%
Weight (g)	4
Operating Temperature ($^{\circ}$ C)	-20~+60

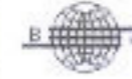
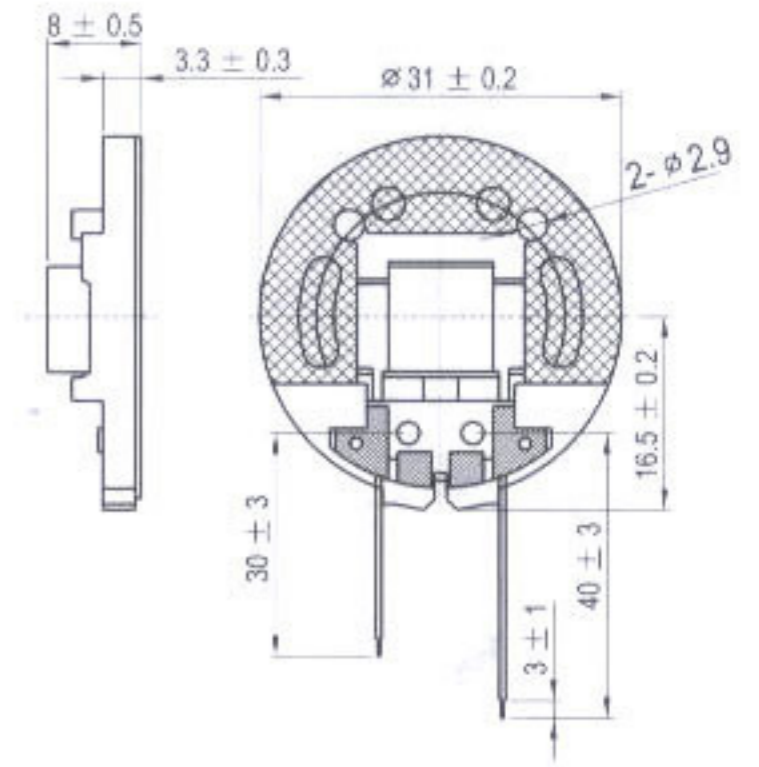
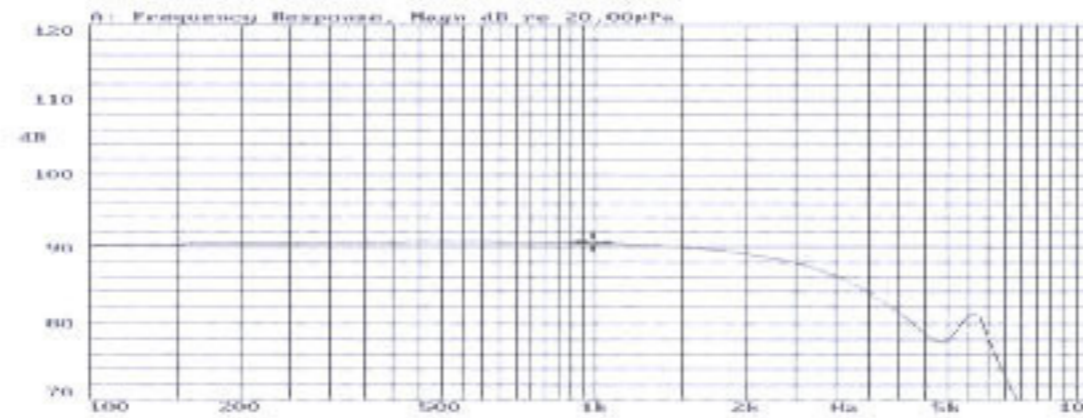

SD-25

DC Resistance (Ω)	130 \pm 15%
AC Impedance at 1 kHz (Ω)	150 \pm 20%
Sensitivity at 1 kHz (dB)	96 \pm 2 at 100mV
Frequency Range (Hz)	300~3400
THD at 105dB with 300~3400Hz	\leq 5%
Weight (g)	4
Operating Temperature ($^{\circ}$ C)	-20~+60

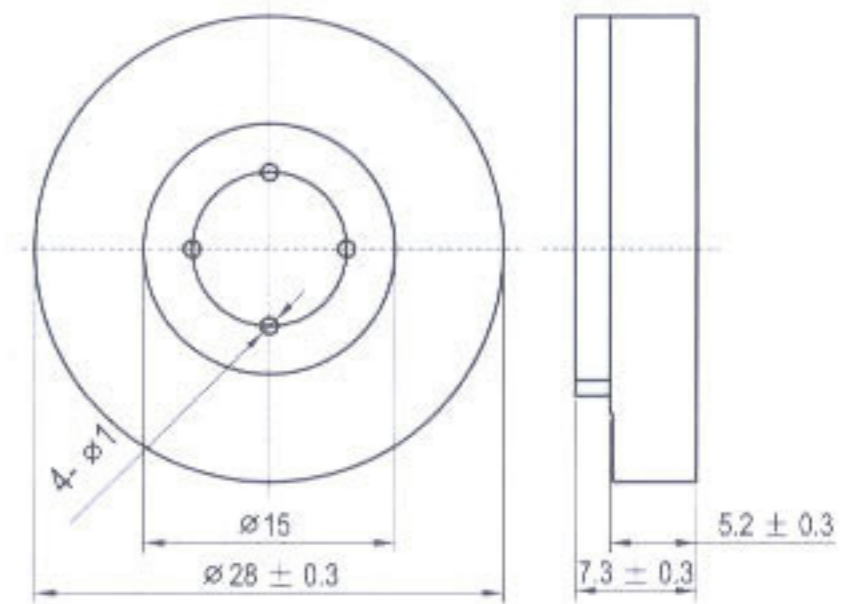
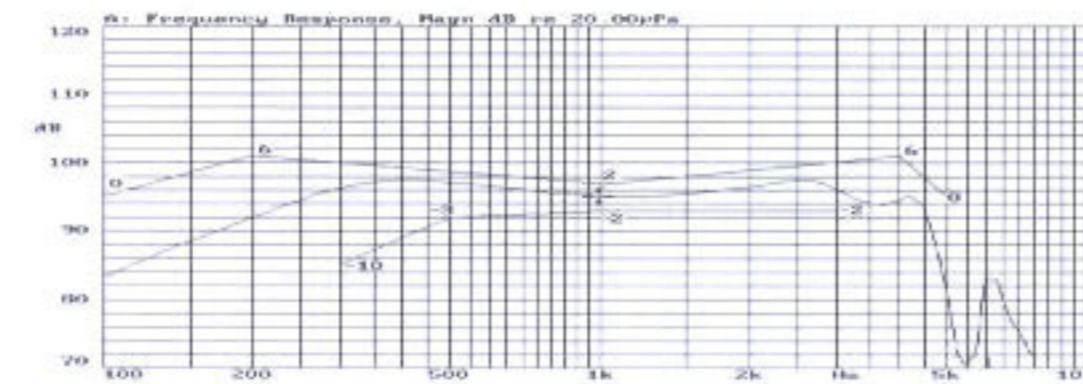

SD-26

DC Resistance (Ω)	135 \pm 15
AC Impedance at 1 kHz (Ω)	150 \pm 30
Sensitivity at 1 kHz (dB)	99 \pm 2 at 60mV
Frequency Range (Hz)	300~3400
THD at 1 kHz	\leq 3%
Weight (g)	38
Operating Temperature ($^{\circ}$ C)	-20~+55

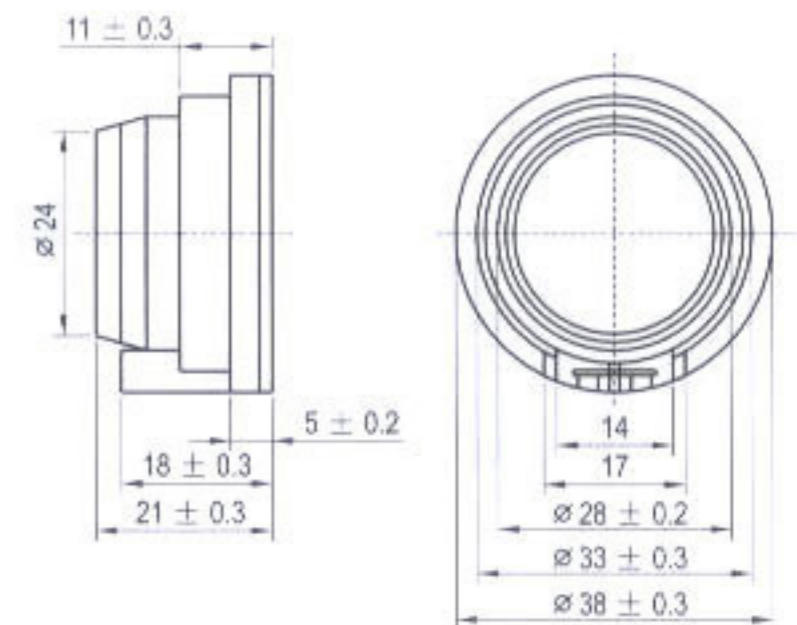
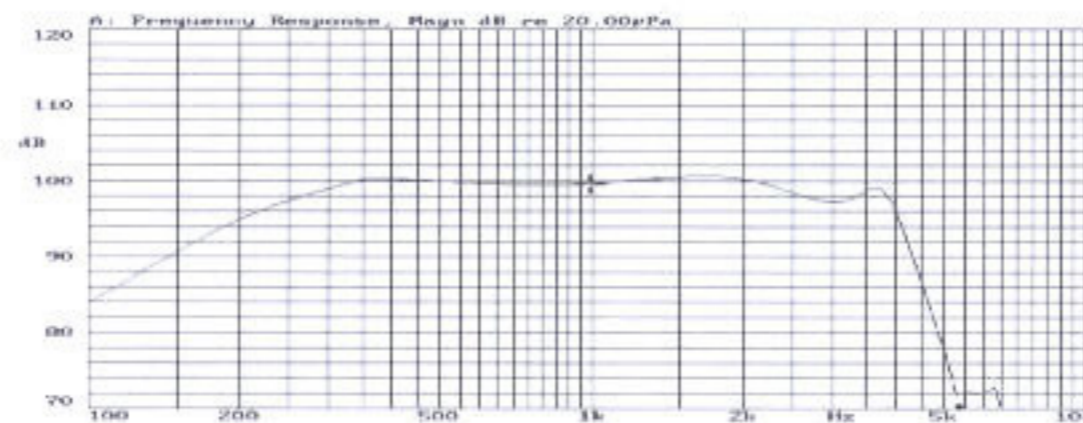

SD-26H

DC Resistance (Ω)	135 \pm 15
AC Impedance at 1 kHz (Ω)	150 \pm 30
Sensitivity at 1 kHz (dB)	99 \pm 2 at 60mV
Frequency Range (Hz)	300~3400
THD at 1 kHz	\leq 3%
Weight (g)	39
Operating Temperature ($^{\circ}$ C)	-20~+55

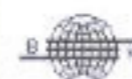
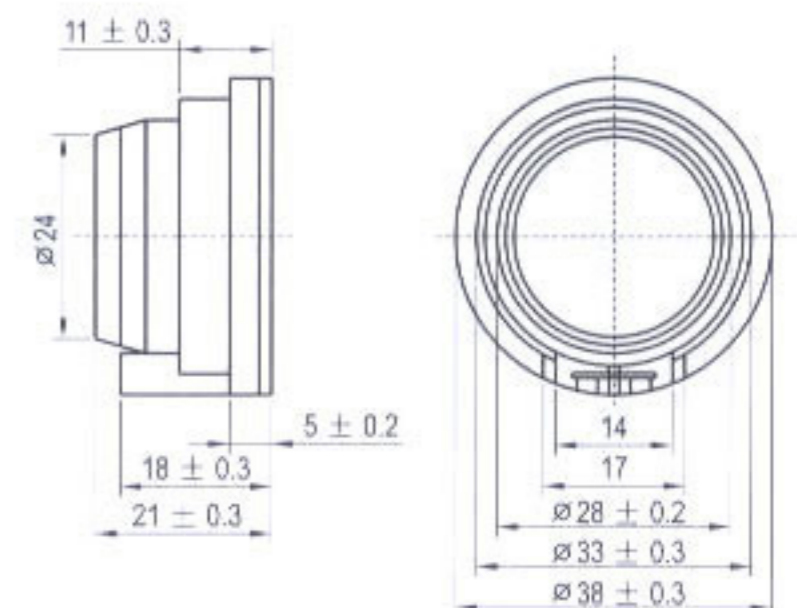
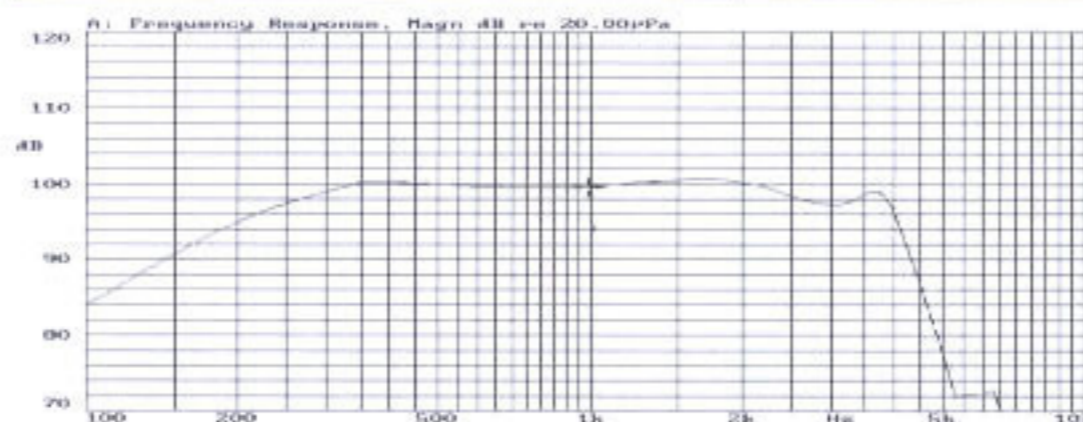



SD-29

DC Resistance (Ω)	135 ± 15%
AC Impedance at 1 kHz (Ω)	150 ± 20%
Sensitivity at 1 kHz (dB)	97 ± 2 at 60mV
Frequency Range (Hz)	300~3400
THD at 300~3400Hz 104dB SPL	≤ 4%
Weight (g)	38
Operating Temperature (°C)	-20~+60

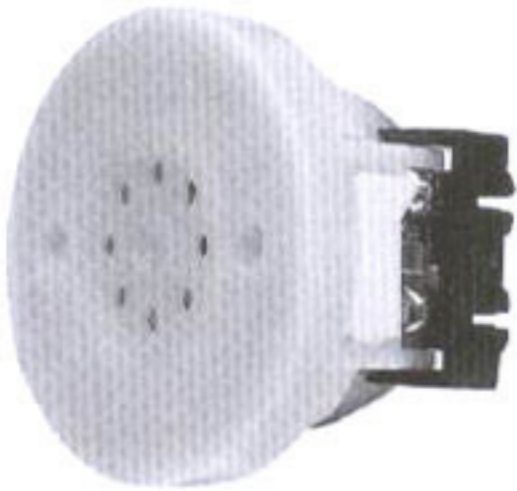
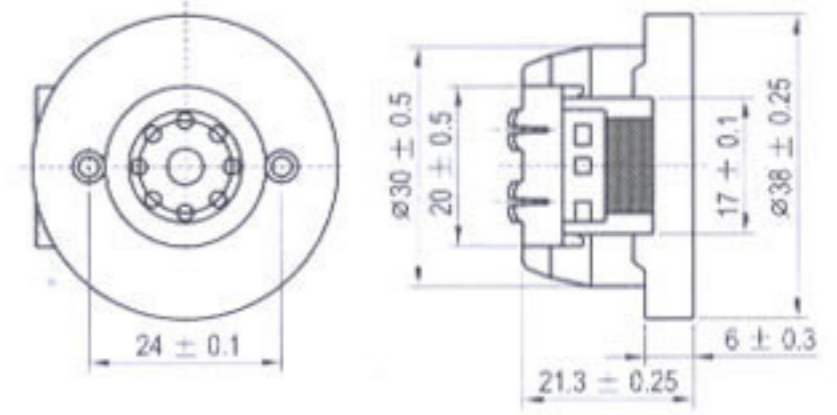
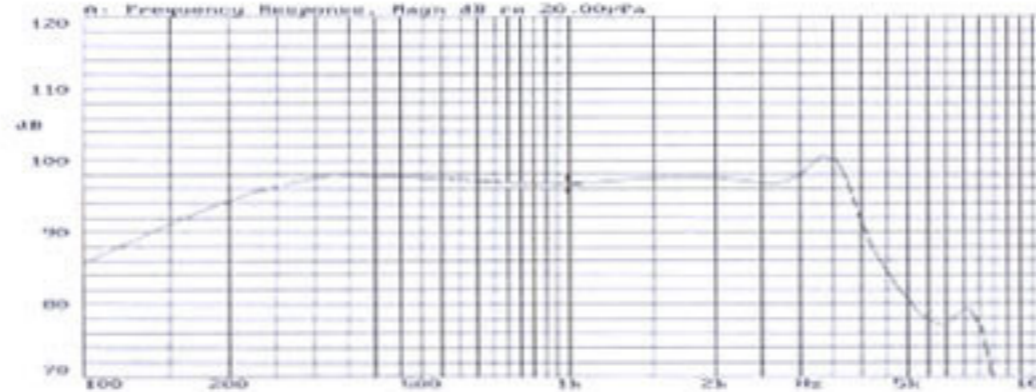

SD-29H

DC Resistance (Ω)	135 ± 15%
AC Impedance at 1 kHz (Ω)	150 ± 20%
Sensitivity at 1 kHz (dB)	96 ± 2 at 60mV
Frequency Range (Hz)	300~3400
THD at 300~3400Hz 104dB SPL	≤ 4%
Weight (g)	38
Operating Temperature (°C)	-20~+60

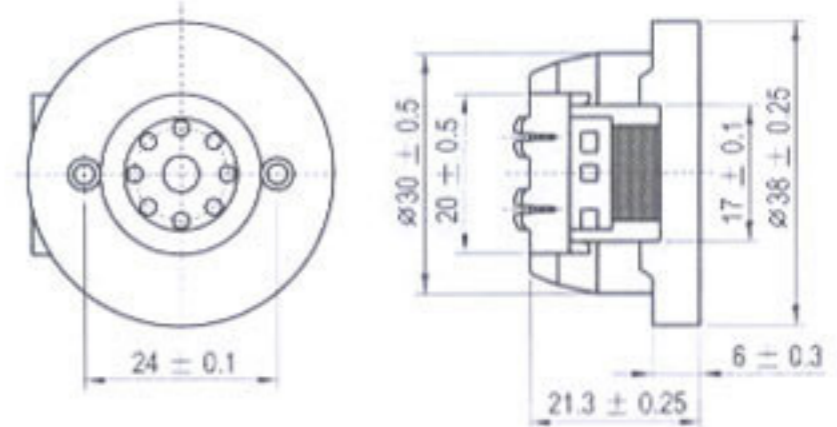
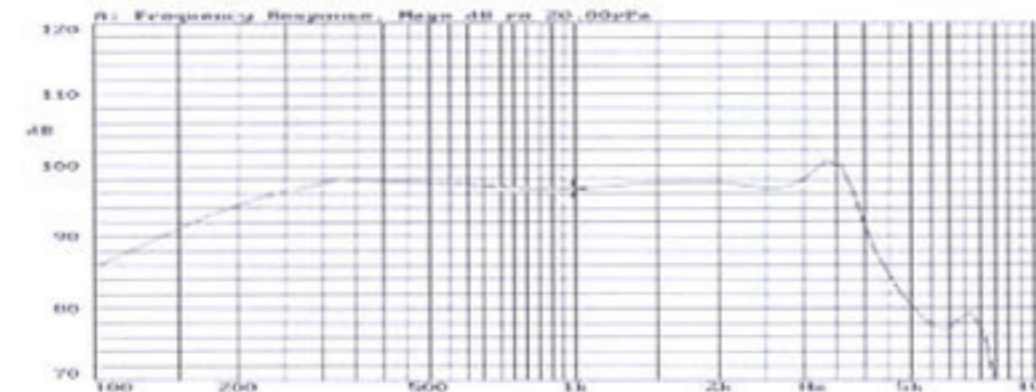

SD-30

DC Resistance (Ω)	135 ± 15
AC Impedance at 1 kHz (Ω)	150 ± 30
Sensitivity at 1 kHz (dB)	110 ± 2 at 1mW
Frequency Range (Hz)	100~4000
THD at 1 kHz 100dB SPL	≤ 5%
Weight (g)	32
Operating Temperature (°C)	-20~+55

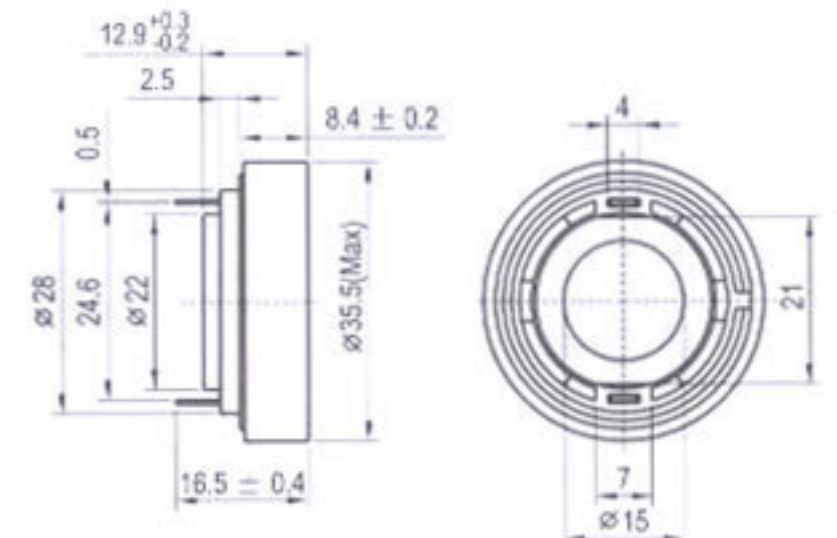

TOL: ± 0.3



SDB-1

DC Resistance (Ω)	135 ± 15
AC Impedance at 1 kHz (Ω)	150 ± 30
Sensitivity at 1 kHz (dB)	108 ± 3 at 1mW
Frequency Range (Hz)	300~3400
THD at 1 kHz	≤ 5%
Weight (g)	15
Operating Temperature (°C)	-20~+55

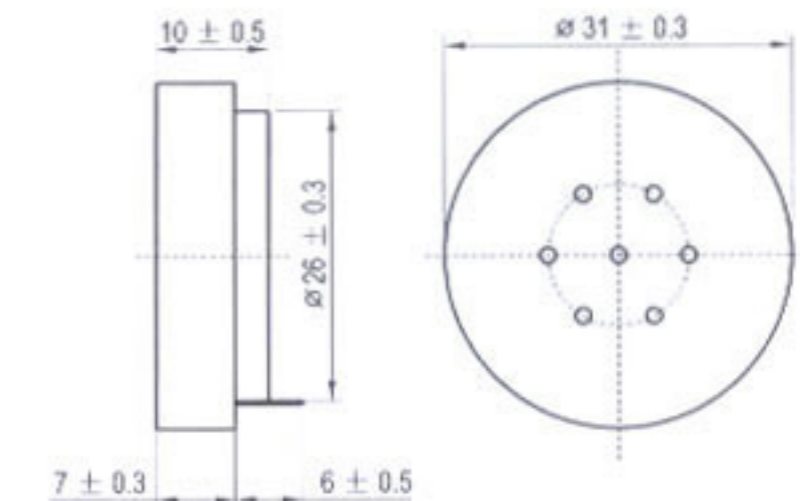
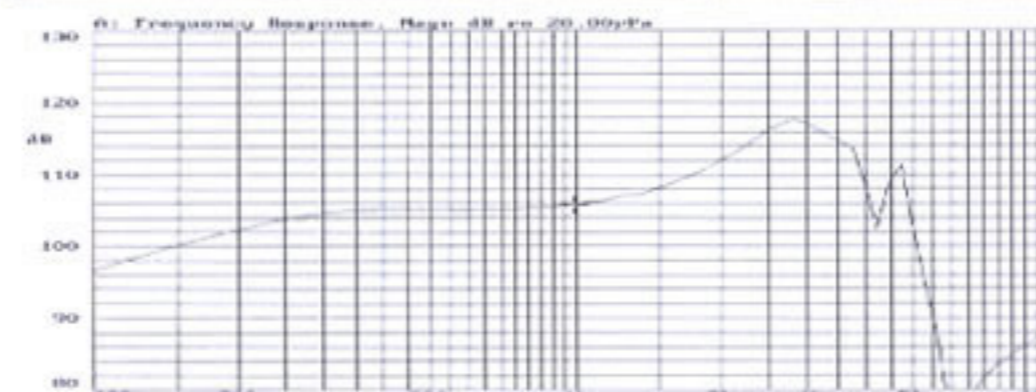

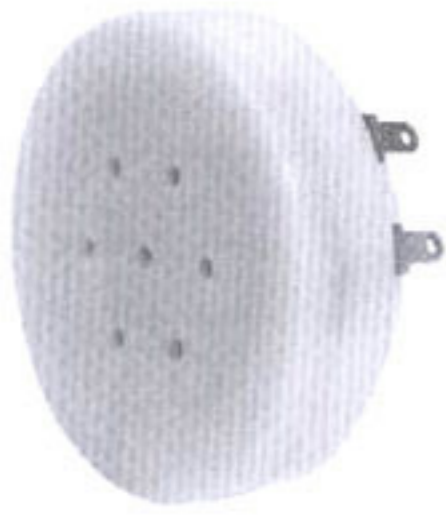

SDB-1H

DC Resistance (Ω)	135 ± 15
AC Impedance at 1 kHz (Ω)	150 ± 30
Sensitivity at 1 kHz (dB)	107 ± 3 at 1mW
Frequency Range (Hz)	300~3400
THD at 1 kHz	≤ 5%
Weight (g)	15
Operating Temperature (°C)	-20~+55

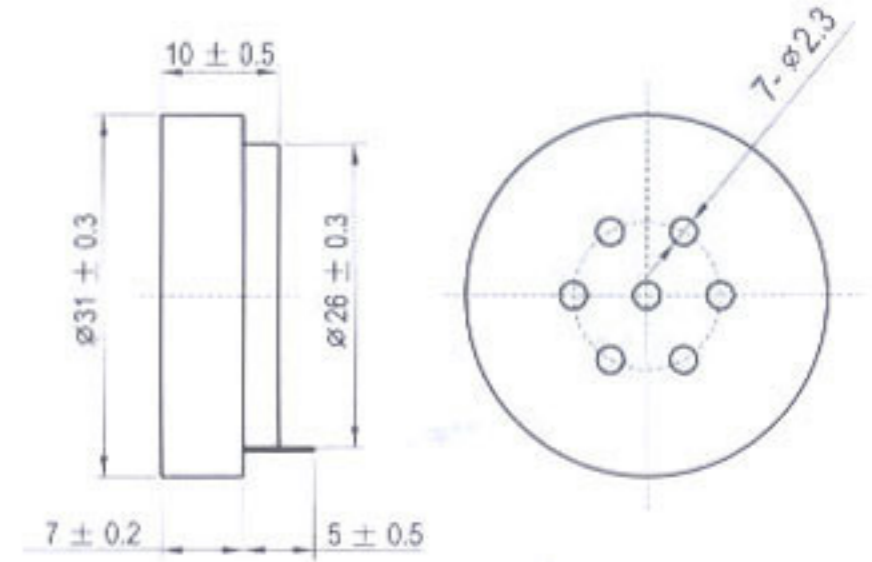
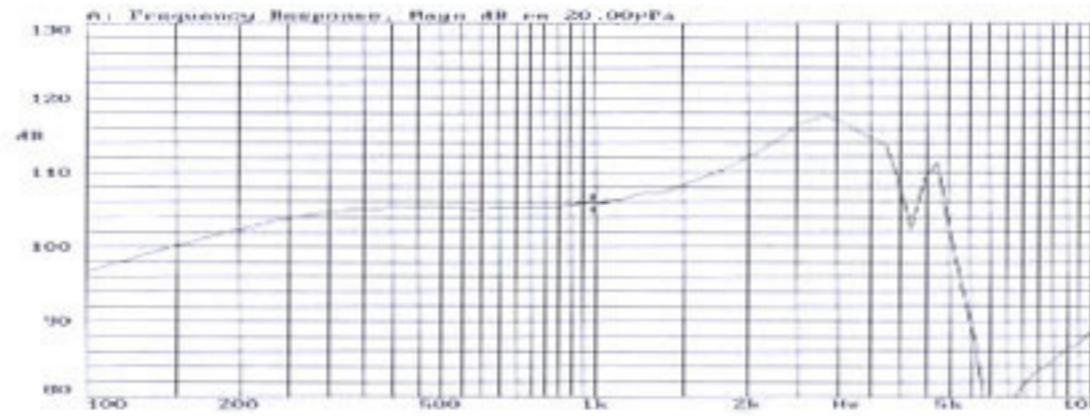

SDB-1SB

DC Resistance (Ω)	135 ± 10%
AC Impedance at 1 kHz (Ω)	150 ± 20%
Sensitivity at 1 kHz (dB)	106 ± 3 at 1mW
Frequency Range (Hz)	100~3400
THD at 1 kHz	≤ 2%
Weight (g)	15
Operating Temperature (°C)	-20~+55

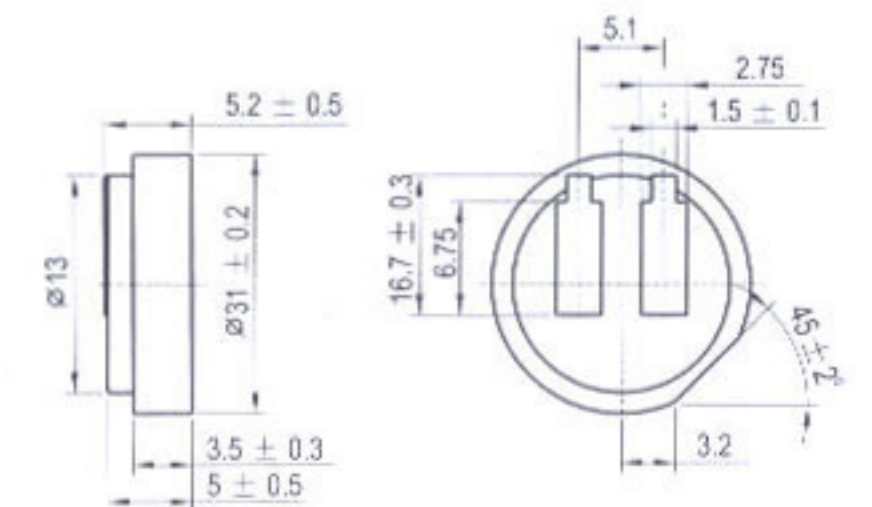
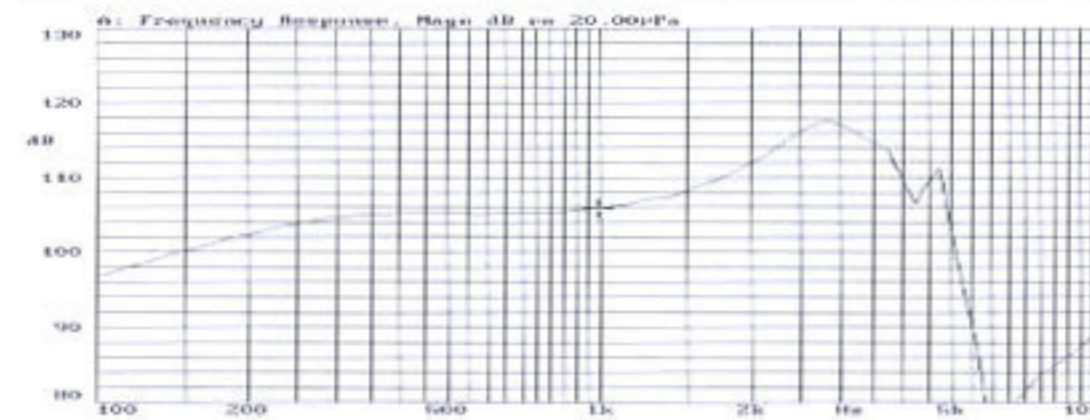

Color: black



SD-1542A-100

DC Resistance (Ω)	90 ± 15%
AC Impedance at 1 kHz (Ω)	100 ± 20%
Sensitivity at 1 kHz (dB)	100 ± 3 at 387mV
Frequency Range (Hz)	300~3400
THD at 1 kHz 60mV	≤ 5%
Weight (g)	1.2
Operating Temperature (°C)	-20~+60

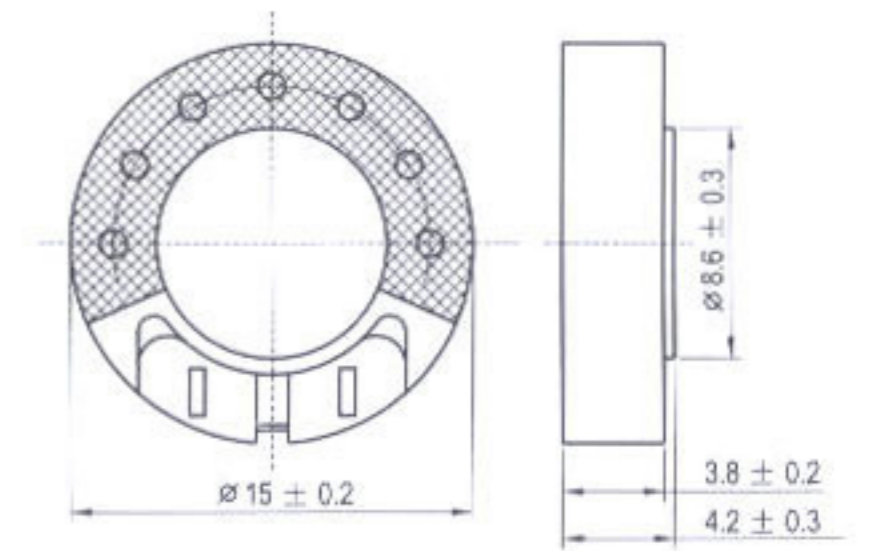
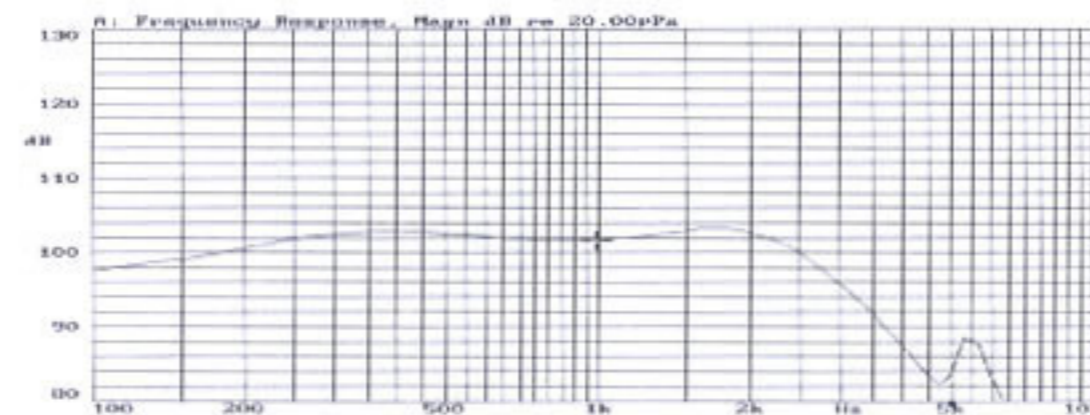

SD-2305B-150

DC Resistance (Ω)	130 ± 15%
AC Impedance at 1 kHz (Ω)	150 ± 20%
Sensitivity at 1 kHz (dB)	94 ± 3 at 60mV
Frequency Range (Hz)	300~3400
THD at 1 kHz 100dBSPL	≤ 5%
Weight (g)	4.5
Operating Temperature (°C)	-20~+60

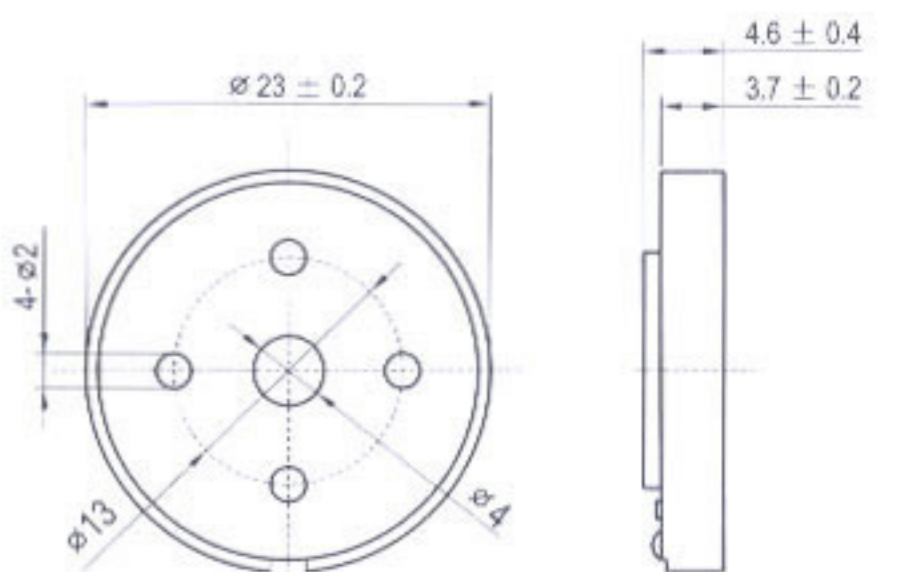
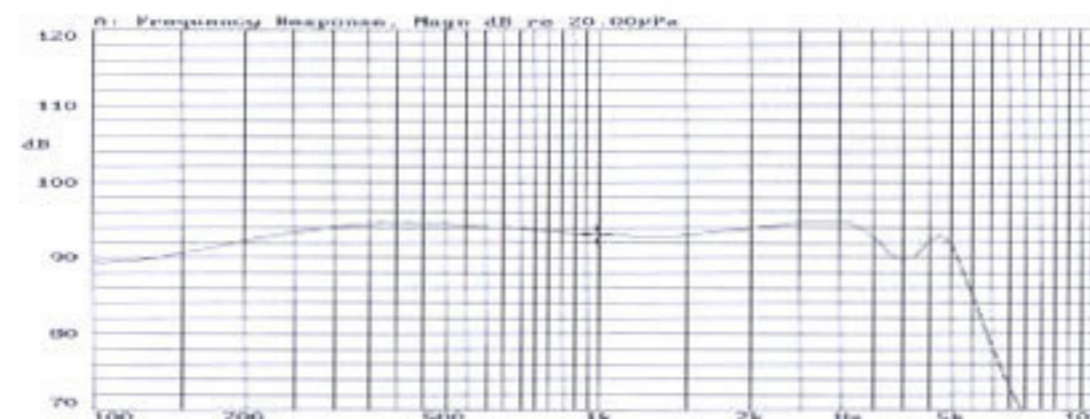



SD-381LC

DC Resistance (Ω)	$70 \pm 15\%$
AC Impedance at 1 kHz (Ω)	$90 \pm 20\%$
Sensitivity at 1 kHz (dB)	96 ± 2 at 60mV
Frequency Range (Hz)	180~5000
THD at 0.3~3.4kHz 100mV	$\leq 3\%$
Weight (g)	41
Operating Temperature ($^{\circ}\text{C}$)	-20~+60

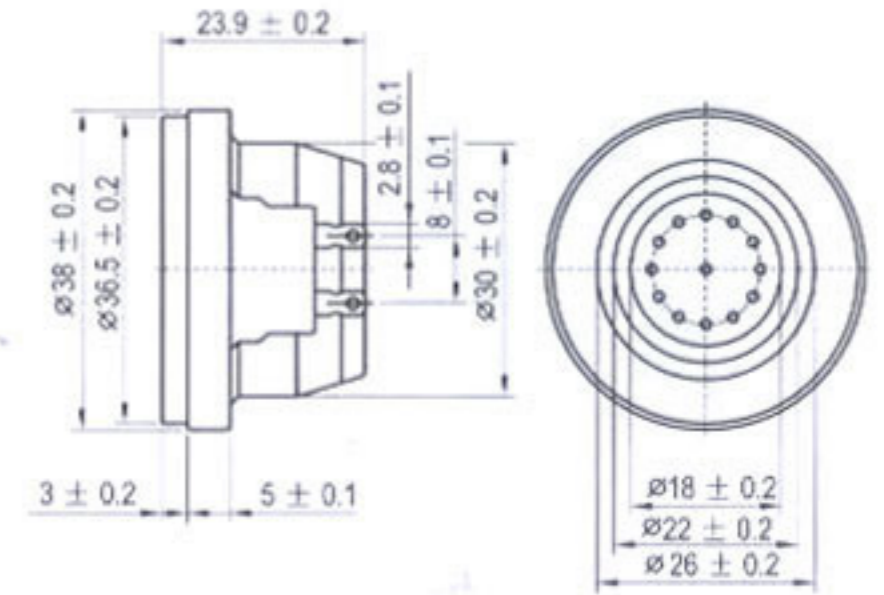
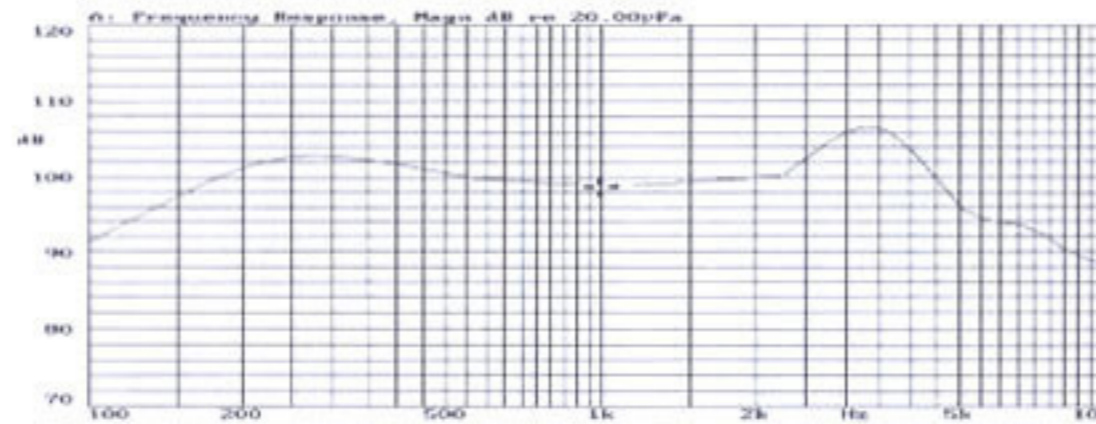

SDR1532

DC Resistance (Ω)	$29 \pm 7\%$
AC Impedance at 1 kHz (Ω)	$32 \pm 15\%$
Sensitivity at 1 kHz (dB)	112 ± 2 at 179+mV
Frequency Range (Hz)	300~3400
THD at 1 kHz 179mV	$\leq 2\%$
Weight (g)	1.25
Operating Temperature ($^{\circ}\text{C}$)	-40~+85

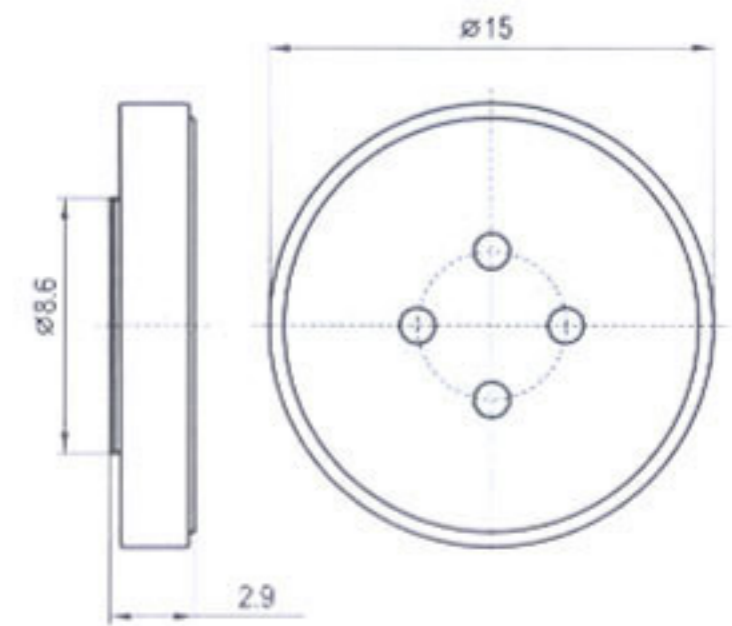
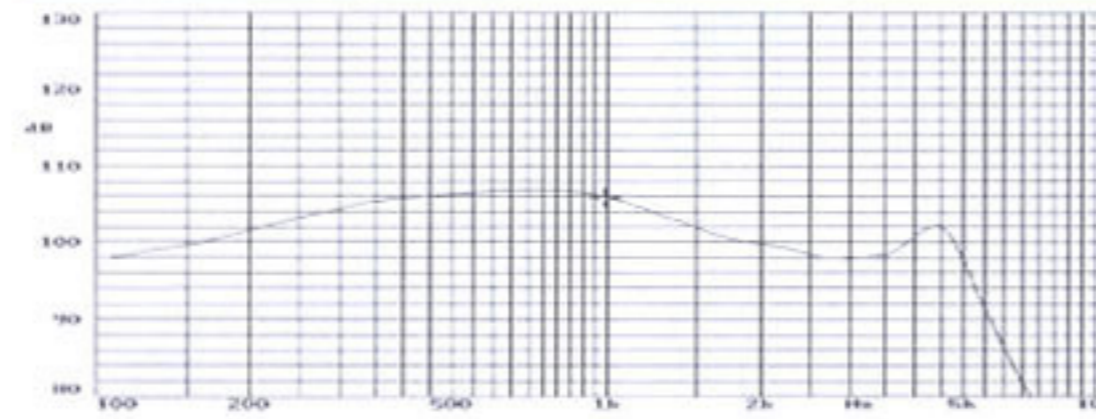

SDRS20160CS

DC Resistance (Ω)	$150 \pm 20\%$
AC Impedance at 1 kHz (Ω)	$160 \pm 20\%$
Sensitivity at 1 kHz (dB)	109 ± 2 at 1mW
Frequency Range (Hz)	300~3400
THD at 1 kHz 100mV	$\leq 3\%$
Weight (g)	2.5
Operating Temperature ($^{\circ}\text{C}$)	-30~+60

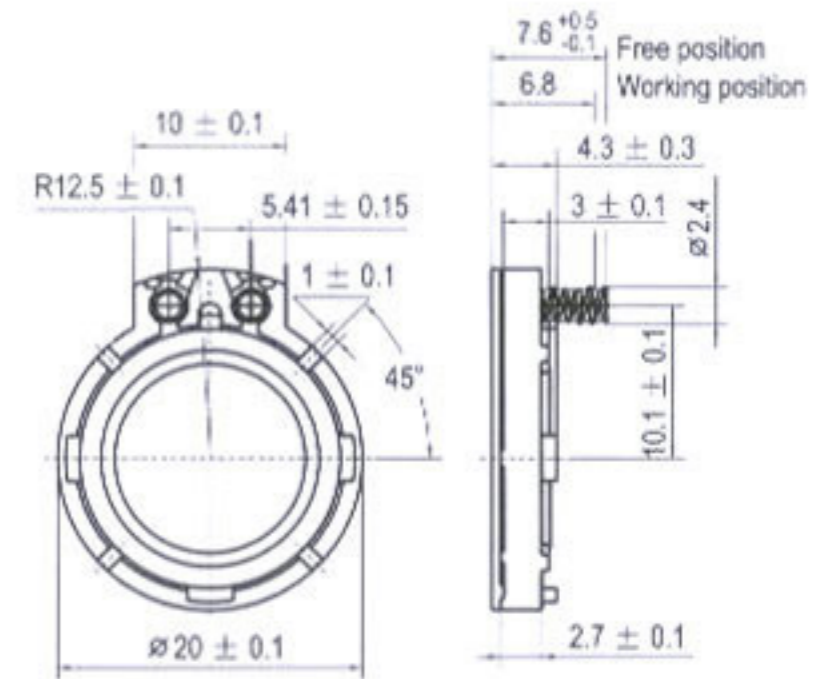
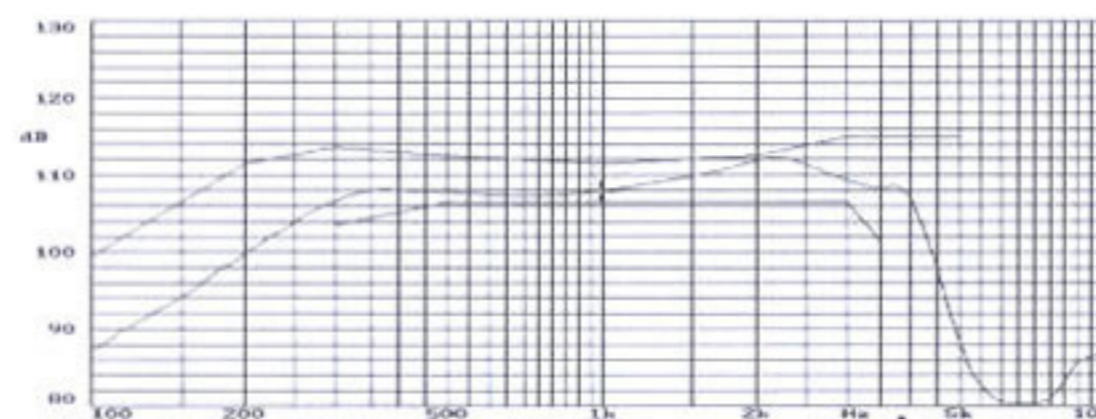

SDR2032A

DC Resistance (Ω)	$29 \pm 10\%$
AC Impedance at 1 kHz (Ω)	$32 \pm 15\%$
Sensitivity at 1 kHz (dB)	99.5 ± 3 at 1mW
Frequency Range (Hz)	300~3400
THD at 1 kHz 100mV	$\leq 3\%$
Weight (g)	2.5
Operating Temperature ($^{\circ}\text{C}$)	-40~+85

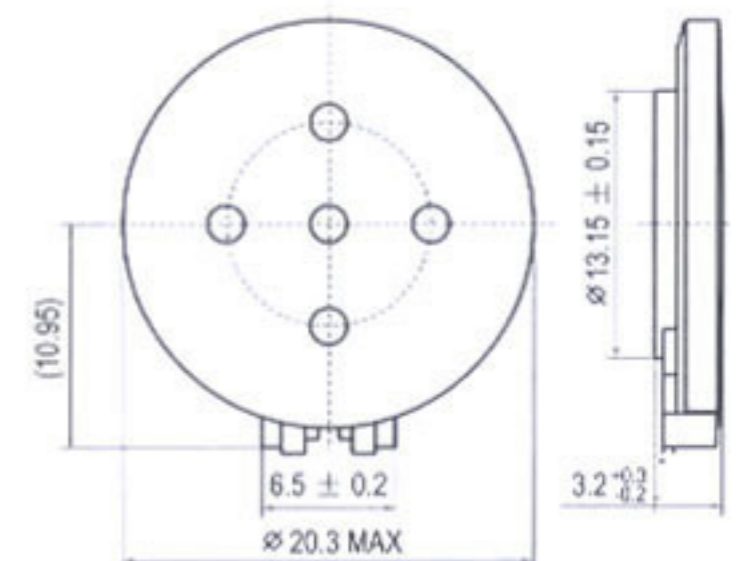
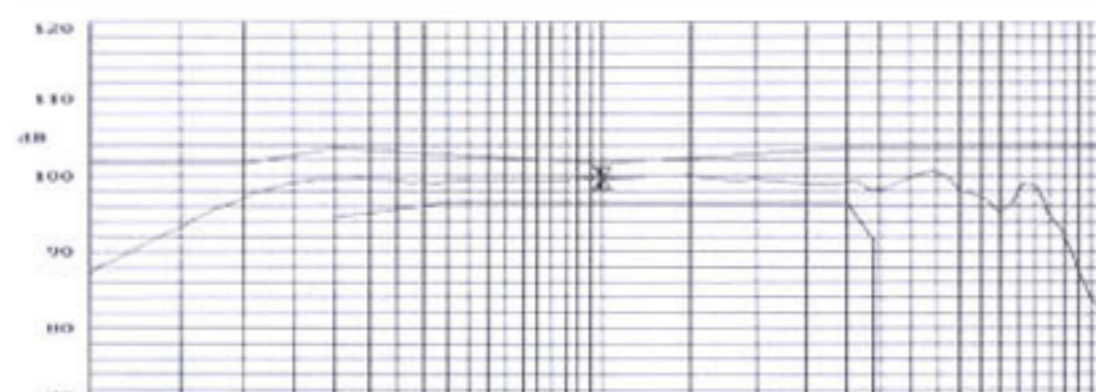



SDR-2138P-150

DC Resistance (Ω)	$120 \pm 10\%$
AC Impedance at 1 kHz (Ω)	$150 \pm 15\%$
Sensitivity at 1 kHz (dB)	94.5 ± 3 at 100mV
Frequency Range (Hz)	300~5000
THD at 300Hz~3.4KHz 94dB SPL	$\leq 6\%$
Weight (g)	2.7
Operating Temperature ($^{\circ}\text{C}$)	-20~+60

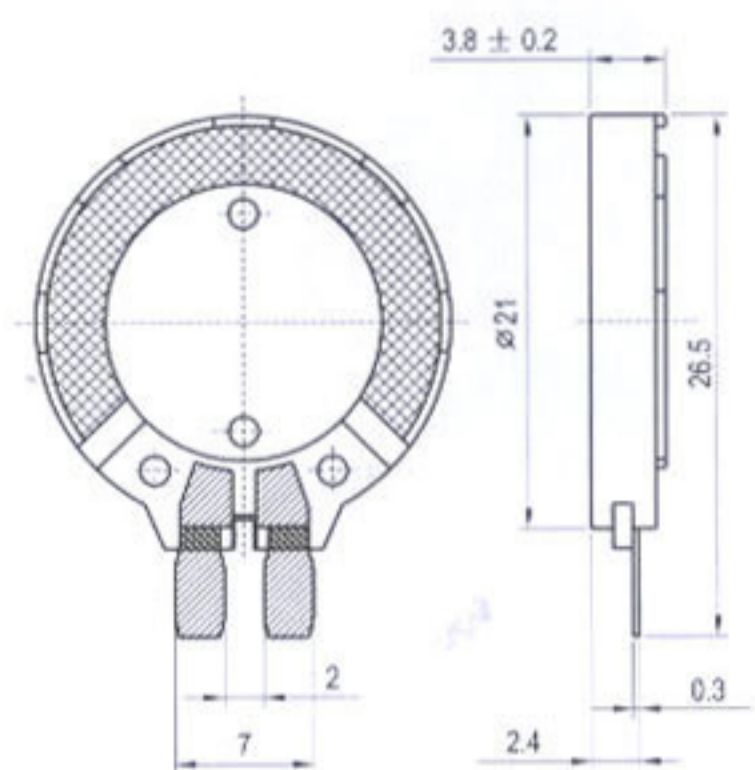
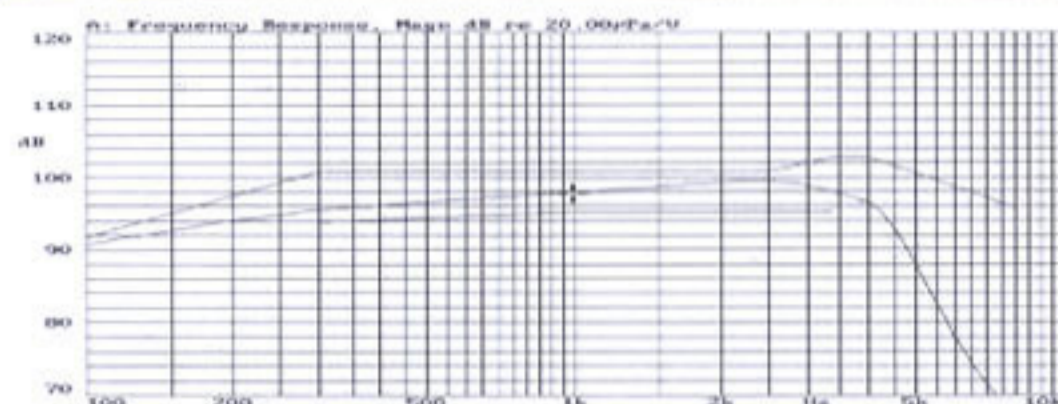

SDR23200

DC Resistance (Ω)	$180 \pm 10\%$
AC Impedance at 1 kHz (Ω)	$200 \pm 20\%$
Sensitivity at 1 kHz (dB)	104 ± 2 at 1mW
Frequency Range (Hz)	300~3400
THD at 1 kHz	$\leq 5\%$
Weight (g)	3.5
Operating Temperature ($^{\circ}\text{C}$)	-20~+40

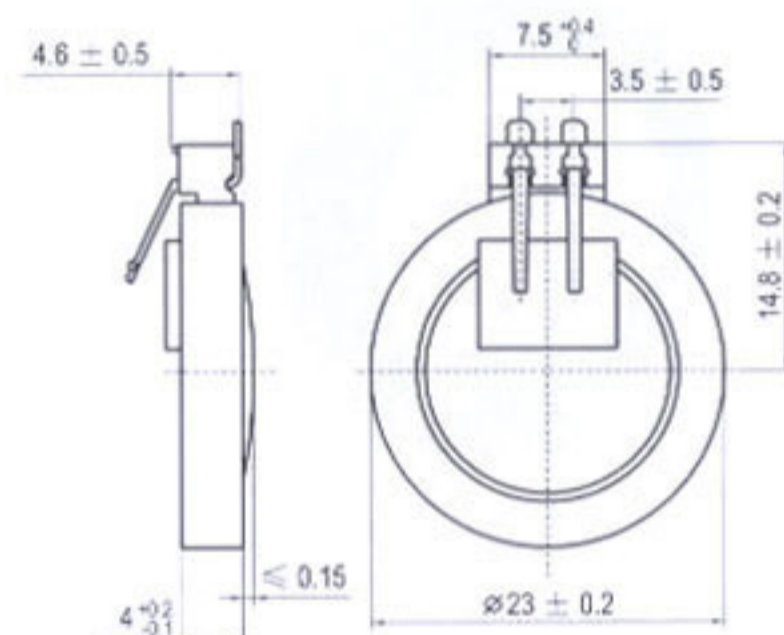
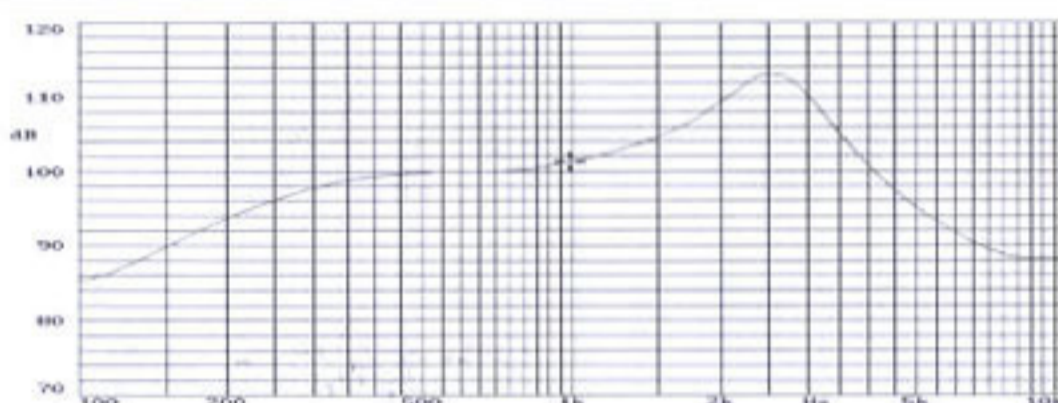

SC-2

DC Resistance (Ω)	$120 \pm 15\%$
AC Impedance at 1 kHz (Ω)	$150 \pm 20\%$
Sensitivity at 1 kHz (dB)	97 ± 3 at 387mV
Frequency Range (Hz)	300~3400
THD at 1 kHz	$\leq 5\%$
Weight (g)	3
Operating Temperature ($^{\circ}\text{C}$)	-20~+70

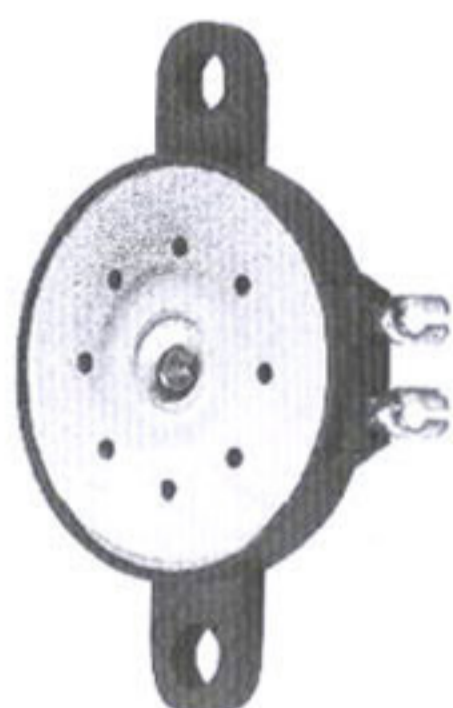
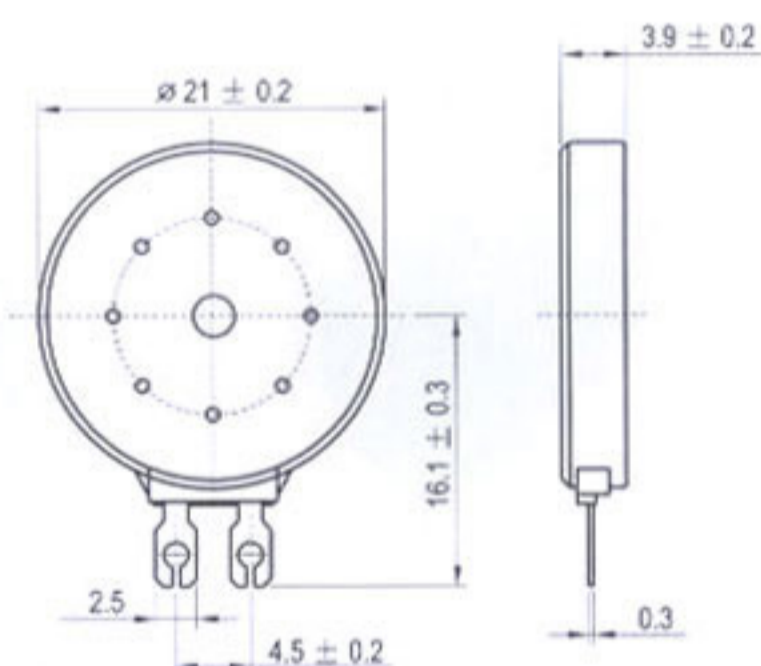
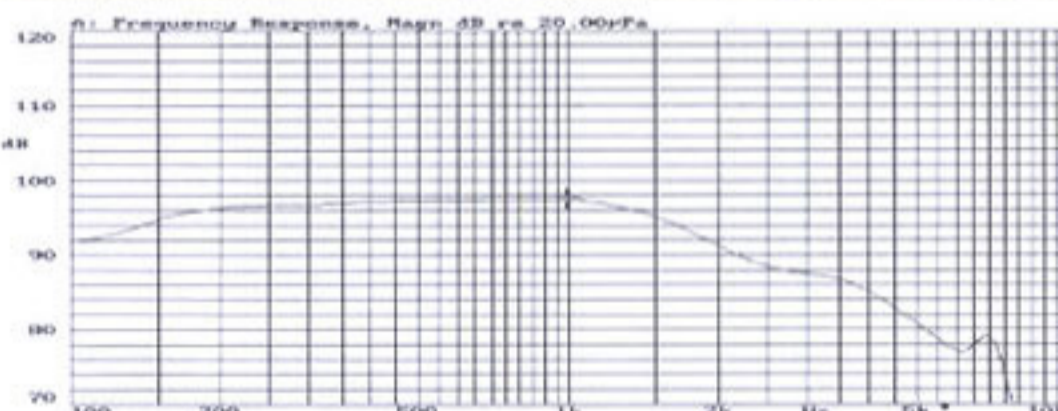

SC-3

DC Resistance (Ω)	$120 \pm 15\%$
AC Impedance at 1 kHz (Ω)	$150 \pm 20\%$
Sensitivity at 1 kHz (dB)	97 ± 3 at 387mV
Frequency Range (Hz)	300~3400
THD at 1 kHz	$\leq 5\%$
Weight (g)	3
Operating Temperature ($^{\circ}\text{C}$)	-20~+70

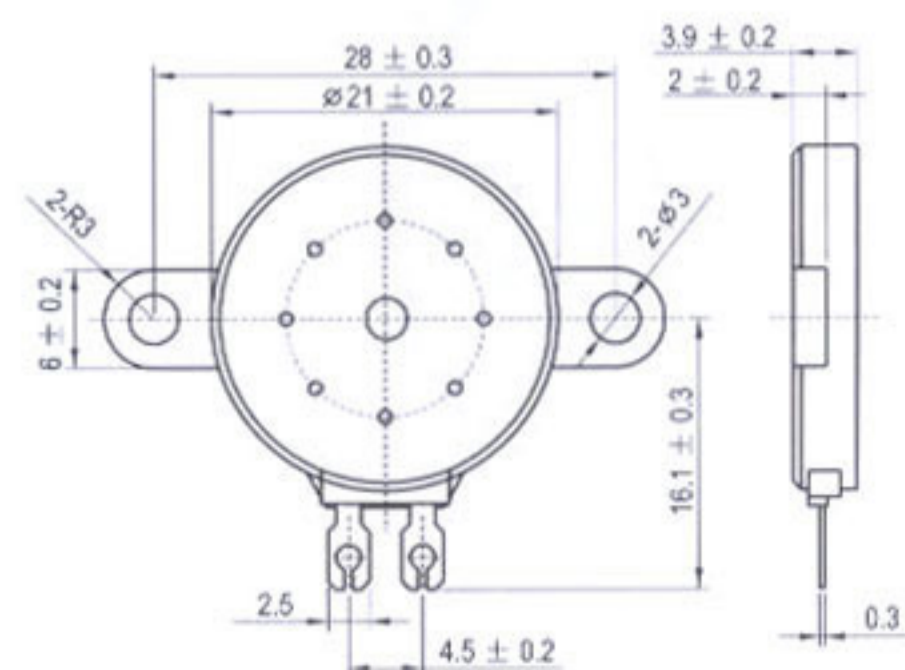
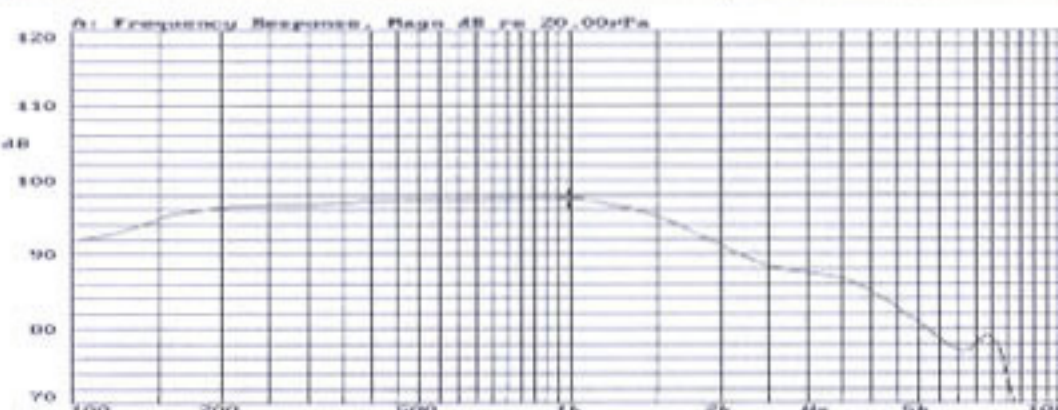



SYD01

Sensitivity at 1kHz (dB)	100~111 at 1Vrms
Capacitance (nF)	55~105
Max. Input (Vrms)	10
Frequency Range (Hz)	300~3400
THD at 1kHz	≤ 1.5%
Weight (g)	1.3
Operating Temperature (°C)	-40~+85

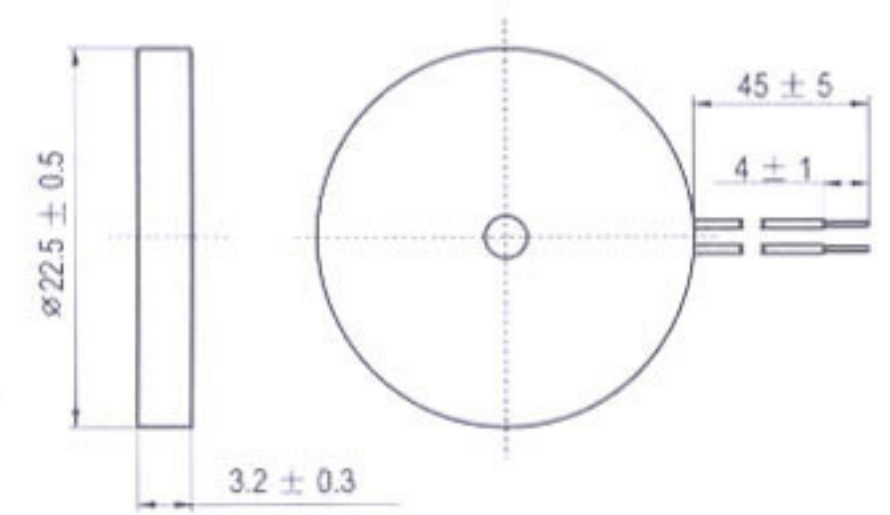
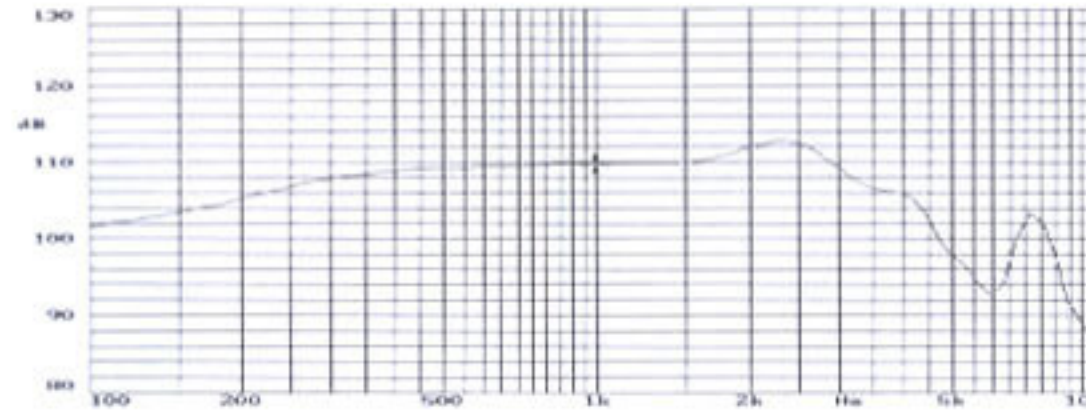

SYJ04

Sensitivity at 1kHz (dB)	107.5 ± 2.5 at 1Vrms
Capacitance (nF)	80 ± 30%
Max. Input (Vrms)	5
Frequency Range (Hz)	300~3400
THD at 1kHz	≤ 1.5%
Weight (g)	1.3
Operating Temperature (°C)	-40~+85

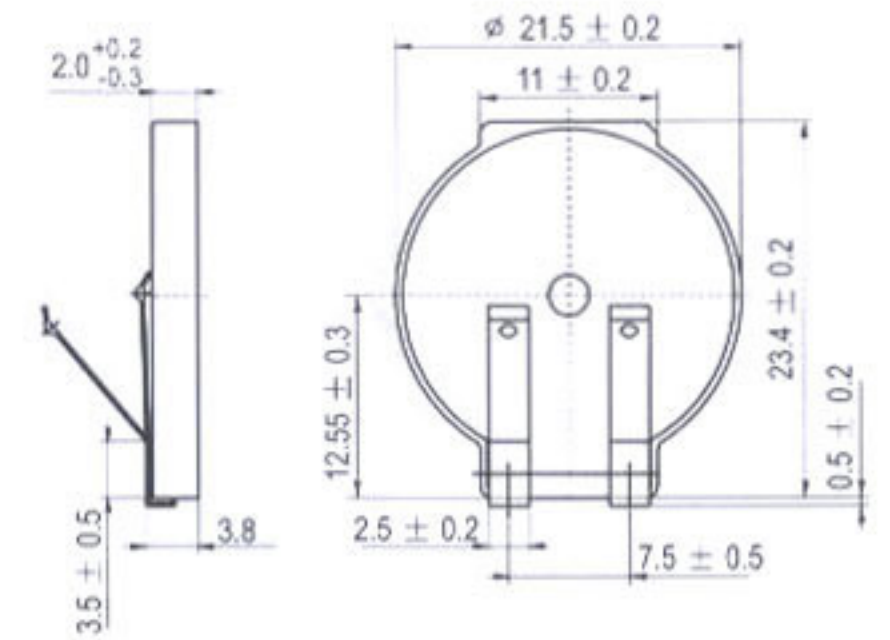
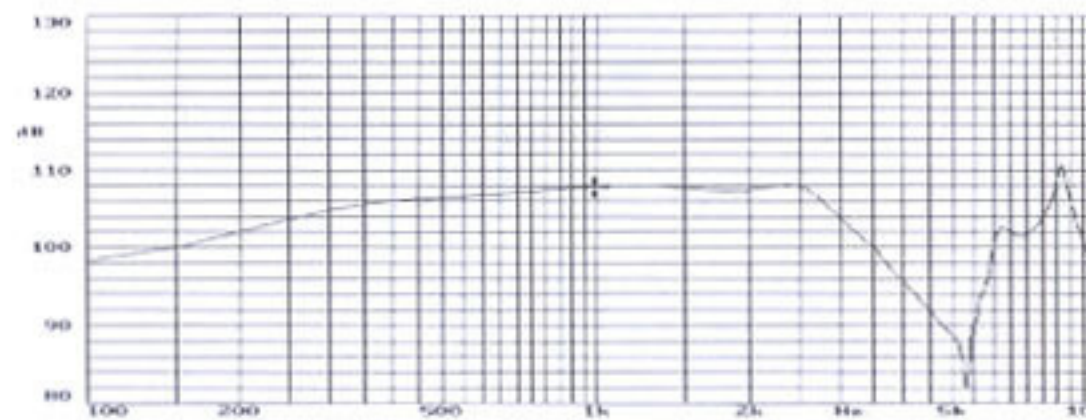

SYK01

Sensitivity at 1kHz (dB)	102~110 at 1Vrms
Capacitance (nF)	35~65
Max. Input (Vrms)	5
Frequency Range (Hz)	300~3400
THD at 1kHz	≤ 2%
Weight (g)	1
Operating Temperature (°C)	-30~+85

